

RANGE  
CATALOGUE  
**2021**

**STIGA**





STIGA machines are engineered, designed and manufactured to the highest standards. They are built to last and deliver high performance.

Complex engineering that is intelligently made, simple to use and maintain.

What makes STIGA stand apart, is our passion to help every gardener enjoy their passion; to love tending their gardens, be they great or small and to get perfect results.

We at STIGA are green fingered engineers, with the hearts of gardeners.



Sean Robinson

**CHIEF EXECUTIVE OFFICER STIGA**

# STIGA RANGE

Our main goal is to ensure gardening is a pleasure making each garden a STIGA garden - a healthy and happy place to be.

We know that every season brings a different range of gardening tasks and we want to ensure that every gardener has the right tool for the job in hand. Every garden is different and so is every gardener and at STIGA we want to ensure that there is a choice to suit every different consumer.

Here at STIGA we have developed three different ranges to suit all our customers and the gardening tasks associated with each season

**The STIGA Essential range**, developed for gardening newbies and those who want to act quick and achieve a certain gardening standard.

**The STIGA Experience range**, the perfect way to experience something new and upgrade tools to take on larger gardening tasks and activities.

**The STIGA Expert range** – this includes the more powerful products for those with larger areas to maintain - perfect for professionals and the exacting gardener.

## ESSENTIAL

**FOR NEW AND  
QUICK GARDENERS**

- Lightweight tools
- Easy to adjust, start, control and use, finally easy to clean and store
- Simple and intuitive functions
- Precise results

## EXPERIENCE

**A STEP-UP  
WITH STIGA**

- Robust tools
- Tougher jobs
- Prolonged session
- Diversified work

## EXPERT

**THESE PRODUCTS  
MAKE YOU AN “EXPERT”**

- Durable
- Superior power output
- For intense working environment
- Customisable performance
- Most robust and responsive control

# Index

STIGA Product assortment



<b>EPOWER</b>	<b>6</b>
Introducing Battery Power	7
<b>FRONT MOWERS</b>	<b>10</b>
Park Pro	14
Park	16
Accessories & Attachments	20
Villa	28
Zero Turns Mowers	30
<b>LAWN TRACTORS</b>	<b>32</b>
e-Ride	34
Estate	38
Tornado	42
Combi	46
Accessories & Attachments	48
<b>STIG ROBOT</b>	<b>52</b>
<b>LAWN MOWERS</b>	<b>56</b>
Twinclip	58
Combi and Collector	62
Multiclip	72
Accessories & Attachments	77
<b>HANDHELDS AND RECYCLING</b>	<b>78</b>
Hedge Trimmers	80
Lawn Trimmers and Brushcutters	86
Chainsaws	96
Garden Multi-Mate	102
Multi-tool	106
Shredder	110
Scarifiers	111
Tillers and Scythe	112
<b>CLEANING</b>	<b>116</b>
High Pressure Cleaners	118
Blowers	122
Sweepers	124
<b>BATTERIES AND CHARGERS</b>	<b>126</b>
<b>ACCESSORIES</b>	<b>128</b>
Safety Clothing	129
Lubricants and Oils	131
<b>TOYS</b>	<b>133</b>



**STIGA E-Power is the next generation of battery power, produced, developed and tested by STIGA.**

Switching to battery is a garden lifestyle trend. Here at STIGA we recognise the wants and needs of all consumers and have designed and engineered a range of battery garden equipment for every gardener and every garden type. STIGA E-Power is the flexible energy that can be used with any tool; STIGA batteries have been developed and tested in all configurations for the ultimate power efficiency and safety. For any garden job there is a STIGA battery tool!



# 20V BATTERY SYSTEM

- The battery is perfectly integrated into the machines and tools
- State of charge always visible, thanks to the 4 LED
- Vent holes prevent overheating and extend battery life
- Smart features include tool recognition to always provide the most suitable performance

## ESSENTIAL SERIES 100



# 48V BATTERY SYSTEM

- Shares the same DNA with the 500, 700, and 900 Series
- The battery communicates with the tool and viceversa
- Integrated black box stores information of the entire battery life-cycle

## EXPERIENCE SERIES 500 SERIES 700

## EXPERT SERIES 900



ESSENTIAL

# 20V BATTERY SERIES 100

The STIGA 20V battery range, 100 Series, includes lightweight, easy to use and intuitive tools, giving precise results with minimum effort. With no cables and no starting problems these lightweight tools are a real pleasure to use and won't tie you down! All you need to do is plug in the battery, push START... and off you go!



# EXPERIENCE 48V BATTERY SERIES 500 & 700

Experience a step-up in your garden, thanks to the STIGA 500 & 700 Series Battery range!

Designed and developed for the passionate and more demanding gardener. If you are already using a battery tool you may be looking for an upgrade or adding to your range. The 500 & 700 Series battery series offers increased power, precision & cutting performance alongside enhanced user comfort.

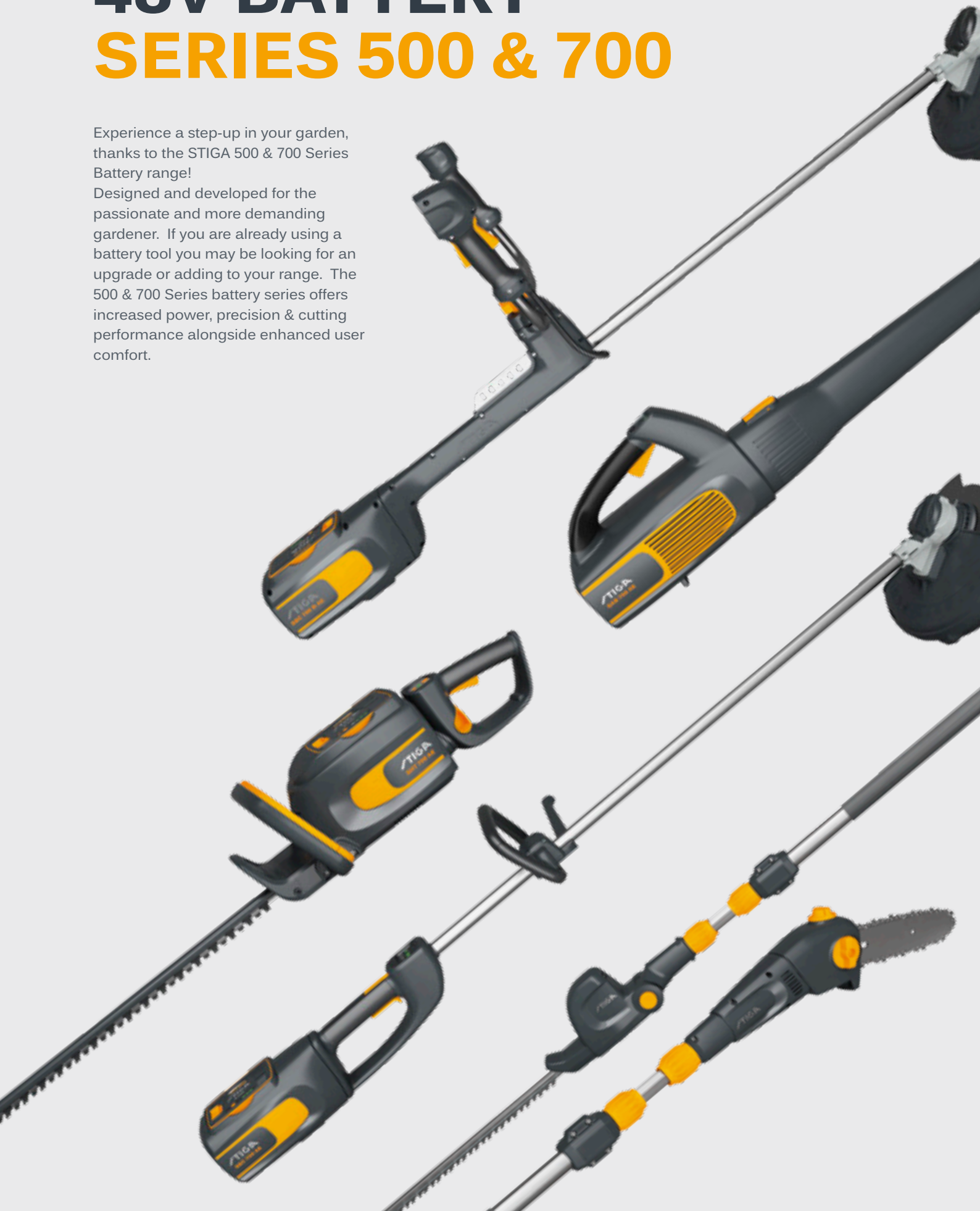



# EXPERT 48V BATTERY SERIES 900

This product range will meet the highest expectations of both gardeners and professionals alike who have previously used petrol mowers and garden tools and now desire to convert to battery. The 900 series is the new STIGA Expert Battery Range offering performance equal to most powerful petrol machines, whilst all the advantages of working with battery tools.



# Front Mowers

Park Pro, Park & Villa



# Meet the challenges of mowing head on

No matter what the garden looks like and how complex it might be: any situation can be managed with a STIGA front mower!

These machines offer great cutting and mulching performance thanks to the high-quality blades, and the unique STIGA articulated steering allows them to easily manoeuvre around obstacles such as trees, stones and flowerbeds.

## Being a STIGA front mower

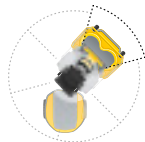

### EASE OF USE

Thanks to STIGA Quick Flip technology, the deck can be placed in the maintenance position within seconds and without the need for any tools.

The RAC connection system allows for the deck to be replaced with one of the many attachments available, full details of the attachments can be found on pages 21 -27.

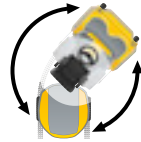

### DRIVING COMFORT

All STIGA Park front-mowers (with the exception of the Park 120 and 220) are articulated machines that can be manoeuvred easily in the most space-restricted areas: the machine bends in the middle and the rear wheels follow the front exactly – drive without worrying about accidental impact.

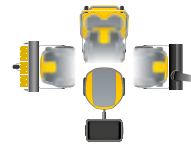

### PERFORMANCE

STIGA front mowers are powered by high-quality twin and single cylinder engines. Efficient and reliable these engines are made from high quality components that are vigorously tested.

## ADDITIONAL FEATURES



### QUICK FLIP

#### QUICK FLIP TECHNOLOGY AND RAC SYSTEM

Raising the deck for cleaning will take less than 30 seconds. Switching front Accessories and attachments can be done without any additional tools.

#### TOP QUALITY MANEUVERABILITY

With STIGA articulated steering, mowing around obstacles is easy and prevents arm fatigue. Top-of-the-range models feature Four-wheel drive traction.

#### COMBI DECKS UP TO 125 CM

A wide range of decks from 85 to 125 cm with 2 or 3 mulching cutting blades. Mulching can be done for fine cutting, while rear discharge suits longer grass.

#### PEDAL OPERATED HYDROSTATIC TRANSMISSION

With no gears to operate, hands remain comfortably on the steering wheel for less tiring and safer cutting sessions.

#### LED HEADLIGHTS

They give greater visibility during low-light sessions, this is particularly useful in Winter.

# PARK 2021

Achieving new standards the sixth generation of Park front mowers are the most innovative, practical and consumer friendly ever introduced and are evolved from the 45-year history of the brand.

The aesthetic redesign of the body ensures a modern style that reflects user demands and improved technical performance, including enhanced air flow that reduces oil temperature by up to 10%. In addition uphill traction on 4WD models has been improved; selected models also benefit from superior lighting and Blue Tooth connectivity via a dedicated App.

**STEEL REAR BUMPER**  
Increasing the robustness in case of accidental impacts



**EXTERNAL FUEL CAP**  
To easy refill, without lifting the bonnet



**ERGONOMIC SIDE PANEL**, from series 300 to series 700 models, with all commands at hand



**REAR REFLECTORS**  
Enhanced visibility when working on public areas



**QUICK FLIP TECHNOLOGY**  
for the easiest way to access the lower part of the deck for maintenance and cleaning





### PERFECT VISIBILITY

A cutting deck positioned in front of the machines for a better view of the job in front.



### NEW LED HEADLIGHTS

- 5 different front LED headlights from 6W to 15W
- Intensively tested to offer the most comfortable experience ever



### IMPROVING THE INVISIBLE

- New improved hydraulic traction system
- Oil flow has been completely reversed
- Efficiency of the 4WD improved by 34%

With stiga 50:50 articulated steering, you can handle any complexity



# Park Pro

Get the job done, eight hours a day

The STIGA Park Pro front-mowers offer the ultimate combination of raw power, flexibility of use and precision cutting.

- **Top mulching performance**
- **Exclusive 50:50 articulated steering with hydro piston**
- **Four-wheel drive traction**
- **Heavy duty structure**
- **Great stability**
- **Hydraulic tool lift**
- **Quick Flip technology**
- **All-seasons machine**

## PRODUCT HERO PARK PRO 740 IOX



## PARK PRO 740 IOX

**STIGA**  
**EXPERT**

- With STIGA 50:50 articulated steering, you can handle any complexity
- Premium 688 cc Honda V-Twin engine
- 4WD ensures the greatest grip on any terrain
- Hydraulic deck and accessories lift
- Can be paired with cutting decks from 110 up to 125 cm
- Quickflip technology to easily clean the deck



PETROL	PARK PRO 740 IOX	PARK PRO 540 IX	PARK PRO 340 IX
Level	<b>EXPERT</b>	<b>EXPERT</b>	<b>EXPERT</b>
Power source	Petrol	Petrol	Petrol
Power	15.4 kW	14.3 kW	11.82 kW
Engine Brand	Honda	Honda	Briggs & Stratton
Engine model	GXV 690	GXV 630	Vanguard 18
Displacement	688 cc	688 cc	570 cc
Engine rotation speed	3200 rpm	3200 rpm	3200 rpm
Fuel tank capacity	15 L	15 L	15 L
Maximum working area	13000 m <sup>2</sup>	12500 m <sup>2</sup>	10000 m <sup>2</sup>
Cutting method	Combi - switch between Multiclip mulching and rear discharge	Combi - switch between Multiclip mulching and rear discharge	Combi - switch between Multiclip mulching and rear discharge
Cutting width	95 -125 cm	95 -125 cm	95 -125 cm
Deck lift	Hydraulic	Hydraulic	Hydraulic
Cutting height adjustment	Electric	Electric	Electric
Traction	Four-wheel drive	Four-wheel drive	Four-wheel drive
Transmission type	Hydrostatic	Hydrostatic	Hydrostatic
Steering type	Articulated (50/50)	Articulated (50/50)	Articulated (50/50)
Power assisted steering	Hydro piston	Hydro piston	Hydro piston
Seat type	Comfort with high back support	Comfort with high back support	Comfort with high back support
Seat adjustment	Single lever	Single lever	Single lever
Front wheel size	17x8.00-8	17x8.00-8	17x8.00-8
Rear wheel size	17x8.00-8	17x8.00-8	17x8.00-8
Headlights	Led	Led	Led
Cruise control	-	-	Optional
PTO engagement	Electromagnetic	Electromagnetic	Electromagnetic
Trailer hitch kit	Included	Included	Included
Product weight	270 kg	273 kg	254 kg
Art.-Nr.	2F6430931/ST1	2F6430831/ST1	2F6430621/ST1
Warranty	5-Year Domestic 1-Year Commercial	5-Year Domestic 1-Year Commercial	5-Year Domestic 1-Year Commercial

## PARK 640 PWX

**STIGA**  
EXPERIENCE

- Ultra-powerful 586cc twin-cylinder STIGA ST 600 Twin engine
- All-wheel-drive Tuff Torq transaxle transmission for better climbing
- Front-mounted deck with cutting widths from 95cm to 110cm
- High-back-support seat and ergonomic dashboard with big compartment
- Bluetooth module and app notifies of tasks, such as maintenance
- Bluetooth module and app notifies of tasks, such as maintenance
- High-beam LED headlights



PETROL	PARK 740 PWX	PARK 640 PWX	PARK 620 PW	PARK 540 PX	PARK 520 P
Level	EXPERIENCE	EXPERIENCE	EXPERIENCE	EXPERIENCE	EXPERIENCE
Power source	Petrol	Petrol	Petrol	Petrol	Petrol
Power	11.82 kW	13.1 kW	13.1 kW	9.3 kW	9.3 kW
Engine Brand	Briggs & Stratton	STIGA	STIGA	STIGA	STIGA
Engine model	Vanguard 18	ST 600 Twin Powered by STIGA	ST 600 Twin Powered by STIGA	ST 500 Powered by STIGA	ST 500 Powered by STIGA
Displacement	570 cc	586 cc	586 cc	452 cc	452 cc
Engine rotation speed	3200 rpm	3200 rpm	3200 rpm	3200 rpm	3200 rpm
Fuel tank capacity	12 L	12 L	12 L	12 L	12 L
Maximum working area	9500 m <sup>2</sup>	8500 m <sup>2</sup>	8000 m <sup>2</sup>	7500 m <sup>2</sup>	6000 m <sup>2</sup>
Cutting method	Combi - switch between Multiclip mulching and rear discharge	Combi - switch between Multiclip mulching and rear discharge	Combi - switch between Multiclip mulching and rear discharge	Combi - switch between Multiclip mulching and rear discharge	Combi - switch between Multiclip mulching and rear discharge
Cutting width	95 - 110 cm	95 - 110 cm	95 - 110 cm	95 - 100 cm	95 - 100 cm
Deck lift	Manual	Manual	Manual	Manual	Manual
Cutting height adjustment	Electric	Electric	Electric	Electric	Electric
Traction	Four-wheel drive	Four-wheel drive	Rear-wheel drive	Four-wheel drive	Rear-wheel drive
Transmission type	Hydrostatic	Hydrostatic	Hydrostatic	Hydrostatic	Hydrostatic
Steering type	Articulated (50/50)	Articulated (50/50)	Articulated (50/50)	Articulated (50/50)	Articulated (50/50)
Power assisted steering	Hydraulic	Hydraulic	Hydraulic	Hydraulic	Hydraulic
Seat type	Comfort with high back support	Comfort with high back support	Comfort with high back support	Comfort	Comfort
Seat adjustment	Single lever	Single lever	Single lever	Single lever	Single lever
Front wheel size	16x7.50-8	16x7.50-8	16x7.50-8	16x7.50-8	16x7.50-8
Rear wheel size	16x7.50-8	16x7.50-8	16x7.50-8	16x7.50-8	16x7.50-8
Headlights	LED - Advanced	LED - Advanced	LED - Advanced	LED - Advanced	LED - Advanced
Cruise control	No	No	No	No	No
PTO engagement	Electromagnetic	Electromagnetic	Electromagnetic	Electromagnetic	Electromagnetic
Trailer hitch kit	Included	Included	Included	Included	Included
Product weight	238 kg	233 kg	215 kg	228 kg	204 kg
Art.-Nr.	2F6230625/ST1	2F6230745/ST1	2F6220745/ST1	2F6230545/ST1	2F6220545/ST1
Warranty	5-Years*	5-Years*	5-Years*	5-Years*	5-Years*

\*Terms & conditions apply



## PARK 345 PWX

**STIGA**  
EXPERIENCE

- Powerful and reliable 530cc Honda GCV530 twin-cylinder engine
- All-wheel-drive Tuff Torq transaxle transmission for better climbing
- Front-mounted deck with cutting widths from 95cm to 100cm
- 50:50 articulated power steering
- Compact side dashboard and comfortable driver area
- Cutting-edge cooling bonnet with external fuel cap



PETROL	PARK 345 PWX	PARK 340 PWX	PARK 320 PW	PARK 320 P
Level	EXPERIENCE	EXPERIENCE	EXPERIENCE	EXPERIENCE
Power source	Petrol	Petrol	Petrol	Petrol
Power	10.8 kW	11.9 kW	11.9 kW	8.1 kW
Engine Brand	Honda	STIGA	STIGA	STIGA
Engine model	GCV 530	ST 550 Twin Powered by STIGA	ST 550 Twin Powered by STIGA	ST 450 Powered by STIGA
Displacement	530 cc	586 cc	586 cc	432 cc
Engine rotation speed	3200 rpm	3200 rpm	3200 rpm	3200 rpm
Fuel tank capacity	12 L	12 L	12 L	12 L
Maximum working area	7500 m <sup>2</sup>	7500 m <sup>2</sup>	7000 m <sup>2</sup>	4000 m <sup>2</sup>
Cutting method	Combi - switch between Multiclip mulching and rear discharge	Combi - switch between Multiclip mulching and rear discharge	Combi - switch between Multiclip mulching and rear discharge	Combi - switch between Multiclip mulching and rear discharge
Cutting width	95 - 100 cm	95 - 100 cm	95 - 100 cm	95 - 100 cm
Deck lift	Manual	Manual	Manual	Manual
Cutting height adjustment	Electric	Electric	Electric	Electric
Traction	Four-wheel drive	Four-wheel drive	Rear-wheel drive	Rear-wheel drive
Transmission type	Hydrostatic	Hydrostatic	Hydrostatic	Hydrostatic
Steering type	Articulated (50/50)	Articulated (50/50)	Articulated (50/50)	Articulated (50/50)
Power assisted steering	Hydraulic	Hydraulic	Hydraulic	Hydraulic
Seat type	Comfort with high back support	Comfort	Comfort	Comfort
Seat adjustment	Single lever	Single lever	Single lever	Single lever
Front wheel size	16x7.50-8	16x7.50-8	16x7.50-8	16x7.50-8
Rear wheel size	16x7.50-8	16x7.50-8	16x7.50-8	16x7.50-8
Headlights	LED	LED	LED	No
Cruise control	No	No	No	No
PTO engagement	Mechanical	Electromagnetic	Electromagnetic	Electromagnetic
Trailer hitch kit	Included	Included	Included	Included
Product weight	226 kg	226 kg	205 kg	202 kg
Art.-Nr.	2F6130535/ST1	2F6130645/ST1	2F6120645/ST1	2F6120545/ST1
Warranty	5-Years*	5-Years*	5-Years*	5-Years*

\*Terms & conditions apply



## PARK 220

**STIGA**  
ESSENTIAL

- STIGA articulated steering makes maneuvering really easy
- Equipped 344 cc Briggs & Stratton petrol engine
- Easy drive, thanks to hydrostatic transmission
- RAC Quick Connect system for easy switch among accessories
- Can be combined with Combi cutting deck with QuickFlip technology



PETROL	PARK 220	PARK 120
Level	ESSENTIAL	ESSENTIAL
Power source	Petrol	Petrol
Power	7.4 kW	7.1 kW
Engine Brand	Briggs & Stratton	STIGA
Engine model	PowerBuilt 3130 AVS	ST 400 Powered by STIGA
Displacement	344 cc	414 cc
Engine rotation speed	3200 rpm	3200 rpm
Fuel tank capacity	4.2 L	4.2 L
Maximum working area	3000 m <sup>2</sup>	2500 m <sup>2</sup>
Cutting method	Combi - switch between Multiclip mulching and rear discharge	Combi - switch between Multiclip mulching and rear discharge
Cutting width	85 - 95 cm	85 cm
Deck lift	Manual	Manual
Cutting height adjustment	Electric	Manual
Traction	Rear-wheel drive	Rear-wheel drive
Transmission type	Hydrostatic	Hydrostatic
Steering type	Articulated	Articulated
Seat type	Standard	Standard
Seat adjustment	Locking knobs	Locking knobs
Front wheel size	14.3x5.60-8	14.3x5.60-8
Rear wheel size	14.3x5.60-8	14.3x5.60-8
Headlights	No	No
Cruise control	No	No
PTO engagement	Electromagnetic	Electromagnetic
Trailer hitch kit	Included	Included
Product weight	172 kg	176 kg
Art.-Nr.	2F5820321/S16	2F5820241/S16
Warranty	3-Year*	3-Year*

BATTERY	E-PARK 220
Level	EXPERIENCE
Charging system	On board charger / plug
Cutting width	95 cm
Deck lift	Manual
Cutting height adjustment	Electric
Blade motor	Electric (5 kW)
Traction	Rear-wheel drive
Transmission type	Electric
Steering type	Articulated
Seat type	Standard
Seat adjustment	Locking knobs
Cruise control	Yes
PTO engagement	Electromagnetic
Integrated display	High-res. color, 5.6" - TFT
Diagnostic system	Yes
Product weight	225 kg
Art.-Nr.	2F5828001/ST1
Warranty	3-Year*



\*Terms & conditions apply



# Accessories and attachments

## Combi decks

STIGA Combi decks combine two mowing techniques, so you are able to choose the best cutting method, depending on the lawn's conditions. Mulching is perfect for fine cutting and naturally fertilizing the lawn. If grass has grown tall, rear discharge may be preferable.

The cutting decks are fitted with 2 or 3 blades depending on the model and are aerodynamically shaped offering excellent mulching performance. View the deck compatibility chart to find the deck(s) recommended for each Park front mower.



**QUICK  
FLIP**

### QUICK FLIP TECHNOLOGY

Raising the deck for cleaning or maintenance will take less than 30 seconds and it won't require any additional tool.





### PARK 125 C PRO EL QF

### PARK 110 C PRO EL QF

### 100 COMBI 3 EL QF

Cutting method	Combi - switch between Multiclip mulching and rear discharge	Combi - switch between Multiclip mulching and rear discharge	Combi - switch between Multiclip mulching and rear discharge
Cutting height adjustment	Electric	Electric	Electric
Cutting height range	25 - 90 mm	25 - 90 mm	25 - 90 mm
Number of blades	3	3	3
Product weight	75 kg	72 kg	55 kg
Art. N.	<b>2D6312521/ST1</b>	<b>2D6311021/ST1</b>	<b>2D6210021/ST1</b>
Warranty	<b>2-Years</b>	<b>2-Years</b>	<b>2-Years</b>



### PARK 105 COMBI EL QF

### PARK 95 COMBI EL QF

### PARK 95 COMBI EL QF

Cutting method	Combi - switch between Multiclip mulching and rear discharge	Combi - switch between Multiclip mulching and rear discharge	Combi - switch between Multiclip mulching and rear discharge
Cutting height adjustment	Electric	Electric	Electric
Cutting height range	25 - 85 mm	25 - 85 mm	25 - 85 mm
Number of blades	2	2	2
Product weight	50 kg	47 kg	49 kg
Art. N.	<b>2D6210521/ST1</b>	<b>2D6209521/ST1</b>	<b>2D5809521/S16</b>
Warranty	<b>2-Years</b>	<b>2-Years</b>	<b>2-Years</b>



### PARK 95 COMBI

### PARK 85 COMBI QF

Cutting method	Combi - switch between Multiclip mulching and rear discharge	Combi - switch between Multiclip mulching and rear discharge
Cutting height adjustment	Manual	Manual
Cutting height range	25 - 85 mm	25 - 85 mm
Number of blades	2	2
Product weight	47 kg	46 kg
Art. N.	<b>2D6209511/S16</b>	<b>2D5808511/S16</b>
Warranty	<b>2-Years</b>	<b>2-Years</b>

# Park deck compatibility



3 blades



2 blades

## PARK

	 QUICK FLIP <b>125 Pro EL QF</b> 2D6312521/ST1	 QUICK FLIP <b>110 Pro EL QF</b> 2D6311021/ST1	 QUICK FLIP <b>Park 100 EL QF</b> 2D6210021/ST1
PARK PRO 740 IOX			
PARK PRO 540 IX			
PARK PRO 340 IX			
PARK 740 PWX			
PARK 640 PWX			
PARK 540 PX			
PARK 345 PWX			
PARK 340 PWX			
PARK 620 PW			
PARK 520P			
PARK 320 PW			
PARK 320 P			
E-PARK 220			
PARK 220			
PARK 120			

	 QUICK FLIP <b>Park 105 EL QF</b> 2D6210521/ST1	 QUICK FLIP <b>Park 95 EL QF</b> 2D6209521/ST1		 QUICK FLIP <b>Deck Park 95 EL QF</b> 2D5809521/S16	 QUICK FLIP <b>Deck Park 85 QF</b> 2D5808511/S16
					
					
					
					
					
					
					
					
					
					
					
					
					
					

 Recommended Combination  Compatible Combination

# Implements

## FRONT MOWER PARK

Product name	Art. N.	Pos
Cargo rails for Park Pro	2A0000060/S16	1
Carrier Case	2A4052000/S16	2
Combi cart plastic	13-0952-11	3
Dust cover for sweeper 85 cm	13-3916-61	4
Dust cover for sweeper 95 cm	13-1936-62	4
Edge cutter 2+Four-wheel drive	13-3911-61	5
Fertiliser spreader	13-0955-11	6
Flail mower axle	13-1985-11	7
Flail mower EL. Park 2+4 WD	13-3902-11	8
Flail mower complete Park 2+4 WD	13-0976-11	9
Frame weights 2x17 kg	13-0939-61	10
Grass and leaves collector 42"	13-3926-11	11
Grass and leaves collector 42" compact	2A6107010/S17	12
Lawn rake axle	13-1986-11	13
Lawn rake EL complete, Park 2+4 WD	13-3901-11	14
Lawn rake, complete, Park 2+Four-wheel drive	13-0975-11	15
Main power switch Park Pro	13-0956-11	16
Poly Roller	299900260/0	17
Pro cart galvanized	13-3906-11	18
Protective cover Stiga	2A0000000/S16	19
Rake tool 100 cm Park (in combination with tool lift)	13-3913-11	20
Rake tool 130 cm Park (in combination with tool lift)	13-3914-11	21
Rear tool lift, Electric, Park	13-3919-11	22
Rear tool lift, manual, Park	13-3909-11	23
Rubber scraper bar 120 cm	13-1958-62	24
Rubber scraper Hydraulic blade	13-3934-61	24
Rubber scraper Hydraulic X Blade	13-3933-61	25
Sand spreader Park	13-1975-14	26
Side brush accessory	13-3915-11	27
Snow blade 120 cm Park	13-3917-61	28
Snow Blade for Park 120 -220	2A3107020/S16	29
Snow Blade Park Hydraulic	13-3932-11	30
Snow Chains 16"x7,5	13-0936-61	31
Snow Chains 160/50-8	13-3927-61	31
Snow Chains 17"x8	13-0937-61	31
Snow thrower 2-stage Hydraulic	13-3930-11	32
Snow thrower 2-stage Park Pro	13-0922-12	33
Snow thrower Park 2+Four-wheel drive	13-0974-11	34
Snow tyres spikes	299900450/0	35
Spring hoe	13-0978-61	36
Sweeper for Park 120 - 220	2A1100040/S16	37
Sweeper Park 2+4 WD	13-0977-11	38
Sweeper Park hydraulic	13-3929-11	38
Sweeper Villa e Park 2+Four-wheel drive	13-3918-61	37
Sweeper with collector	13-3910-11	39
Winter wheels Park, pair 16"	2A9000050/S16	40
X blade Park Hydraulic	13-3931-11	41







1  
Cargo rails



2  
Carrier case



3  
Combi cart



4  
Dust cover for sweeper



5  
Edge cutter



6  
Fertiliser spreader

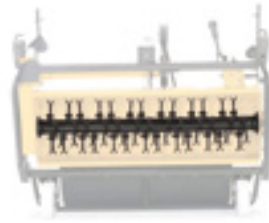

7  
Flail mower axle



8-9  
Flail mower complete



10  
Frame weights



11  
Grass and leaves collector



12  
Grass and leaves collector



13  
Lawn rake axle



14-15  
Lawn rake complete



16  
Main power switch



17  
Poly roller



18  
Pro cart



19  
STIGA protective cover



20-21  
Rake roll



22-23  
Rear tool lift



24  
Rubber scraper bar/blade



25  
Rubber scraper blade



26  
Sand spreader



27  
Side brush accessory



28  
Snow blade



29  
Snow blade



30  
Snow blade



31  
Snow chains



32  
Snow thrower



33  
Snow thrower

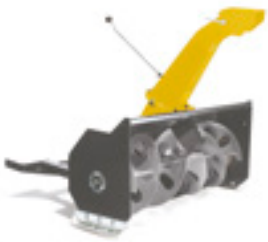

34  
Snow thrower

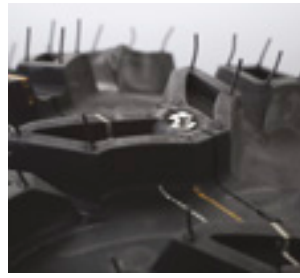

35  
Snow tyres spikes



36  
Spring hoe



37  
Sweeper



38  
Sweeper



39  
Sweeper collector



40  
Winter wheels



41  
Xblade

## Release And Connect (RAC) system

The RAC Quick connection allows you to quickly switch accessories and attachments on a front mower. The operation takes less than one minute and needs no additional tools.

RAC is available as standard on the STIGA Park models and as an option on the STIGA Villa models.

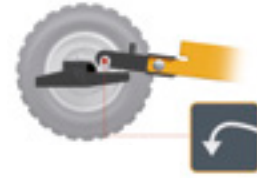

Secure the accessory hook



Move the lever arm up using your foot

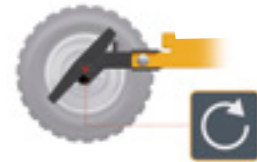

Lock the arm in the correct position

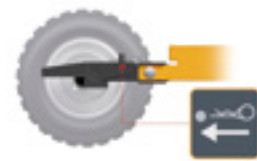

Secure the lock using a split pin

# Villa

## Great versatility, easy management

The STIGA Villa front mower with its light and precise rear wheel steering makes it extremely manoeuvrable. With build quality you can trust the Villa offers outstanding value for money without compromising on performance. The Villa is compatible with a wide range of implements making it an ideal mower for all four seasons.



**STIGA**  
ESSENTIAL

### VILLA 15 HST

- Powered by a STIGA ST 450 singlecylinder engine with 432 cc displacement
- Hydrostatic transmission
- Articulated steering – rear wheels

PETROL	VILLA 15 HST
Level	ESSENTIAL
Power source	Petrol
Power	8.1 kW
Enginge Brand	STIGA
Engine model	ST 450 Powered by STIGA
Displacement	432 cc
Engine rotation speed	3200 rpm
Fuel tank capacity	3.8 L
Maximum working area	2000 m <sup>2</sup>
Cutting method	Combi - switch between Multiclip mulching and rear discharge
Cutting width	85 - 95 cm
Deck lift	Manual
Cutting height adjustment	Manual
Traction	Front-wheel drive
Transmission type	Hydrostatic
Steering type	Rear wheel
Seat type	Comfort
Seat adjustment	Locking knobs
Front wheel size	16x6.00-8
Rear wheel size	13x5.00-6
Headlights	No
Cruise control	No
PTO engagement	Mechanical
Trailer hitch kit	Optional
Product weight	171 kg
Art.-Nr.	2F2720541/ST1
Warranty	3-Years*

\*Terms & conditions apply

## Deck Villa



	VILLA 85 COMBI	VILLA 95 COMBI
<b>Cutting method</b>	Combi - switch between Multiclip mulching and rear discharge	Combi - switch between Multiclip mulching and rear discharge
<b>Cutting height adjustment</b>	Manual	Manual
<b>Cutting height range</b>	25 - 85 mm	25 - 85 mm
<b>Number of blades</b>	2	2
<b>Product weight</b>	39 kg	43 kg
<b>Art.-Nr.</b>	2D2708511/S16	2D2709511/S16
<b>Warranty</b>	2-Year	2-Year

## Accessories

Villa 15 HST

Product name	Art. N.	Pos
Combi cart plastic	13-0952-11	1 •
Dust cover for sweeper 85 cm	13-3916-61	2 •
Fertiliser spreader	13-0955-11	3 •
Frame weights 2x13,5 kg	13-0921-62	4 •
Grass and leaves collector 42" compact	2A6107010/S17	5 •
Poly Roller	299900260/0	6 •
Pro cart galvanized	13-3906-11	7 •
RAC Quick connection	13-0994-61	8 •
Rubber scraper bar 107 cm	13-3904-61	9 •
Snow blade 107 cm universal	13-3922-61	10 •
Snow chains 16"x6	13-0940-61	11 •
Sweeper Villa e Park 2+Four-wheel drive	13-3918-61	12 •



1  
Combi cart plastic



2  
Dust cover for sweeper



3  
Fertiliser spreader



4  
Frame weights



5  
Grass and leaves collector



6  
Poly roller



7  
Pro cart galvanized



8  
RAC quick connection



9  
Rubber scraper bar



10  
Snow blade



11  
Snow chains



12  
Sweeper Villa and Park

# Zero Turn Mowers

Enjoy efficiency and agility

With their two independent hydrostatic transmission and front castor- wheels working to facilitate zero-turn manoeuvres, these advanced, lever-controlled ride-on mowers are extremely nippy and agile and make it quicker and easier to negotiate trees, ornaments, furniture and other garden obstacles.

- **Robust steel deck with three blades**
- **High speed performance**
- **Comfortable seat absorbs vibrations**
- **Foot operated deck lift: for raising and lowering the deck without having to stop**
- **Adjustable control levers: for a customized driving position**
- **Low vibrations**

## Accessories and attachments



1  
Mulching kit



2  
Trailer hitch



3  
Trailer hitch



4  
Mulching kit



5  
Mulching kit

ZT 5132 T  
ZT 7132 T

Product name	Art. N.	Pos	
Mulching Kit (Including blades)	2A0130060/ST1	1	•
Trailer hitch	2A0000060/S17	2	
Trailer hitch	2A0000060/ST1	3	•
ZTR 42" Mulching kit (only plug)	2A0107060/S17	4	
ZTR 52" Mulching Kit (Including blades)	2A0130060/S17	5	•

## Blades



1



2

Code	EAN	Pos	Description	Fits for	Length	Type	Note
1134-9211-02	7313323128263	2	Blade	ZT 5132 T	457	Standard	Package of 3
1134-9238-01	7313324371132	n.a.	Blade	ZT 7132 T	457	Mulching	Package of 3

## ZT 7132 T

- Twin-cylinder Kawasaki engine
- 132 cm welded cutting deck with 3 blades
- Two-lever steering system
- Designed for side discharge

**STIGA**  
**EXPERT**



PETROL	ZT 7132 T	ZT 5132 T
Level	<b>EXPERT</b>	EXPERIENCE
Power source	Petrol	Petrol
Power	16 kW	16.5 kW
Enginge Brand	Kawasaki	Kawasaki
Enginge model	FR691	FR691
Displacement	726 cc	726 cc
Engine rotation speed	2950 rpm	3150 rpm
Fuel tank capacity	19 L	10.5 L
Maximum working area	16000 m <sup>2</sup>	12500 m <sup>2</sup>
Cutting width	132 cm	132 cm
Deck Construction	Fabricated	Fabricated
Deck lift	Manual	Manual
Cutting height adjustment	Manual	Manual
Cutting height range	38 -127 mm	38 -114 mm
Number of blades	3	3
Blade engagement type	Electric	Electric
Traction	Rear-wheel drive	Rear-wheel drive
Transmission type	Hydrostatic	Hydrostatic
Seat type	STIGA comfort plus with padded armrests	STIGA comfort plus with armrests
Seat adjustment	Locking knobs	Single lever
Front wheel size	13x6.50-6	11x4.00-5
Rear wheel size	22x10.50-12	18x8.50-8
PTO engagement	Electromagnetic	Electromagnetic
Max vibration on driver's seat (m/s <sup>2</sup> )	0.55	1
Max vibration on steering wheels (m/s <sup>2</sup> )	2.23	2.8
Product weight	395 kg	279 kg
Art.-Nr.	2F1020861/ST1	2F1020821/S17
Warranty	<b>3-Years* Domestic</b> <b>1-Year Commercial</b>	<b>3-Years* Domestic</b> <b>1-Year Commercial</b>

\*Terms & conditions apply

# Lawn Tractors

Estate, Tornado & Combi





# Born to ride everywhere

Driving through large and complex lawns in total comfort means riding a STIGA lawn tractor. Robust well-equipped machines, with powerful engines and advanced function they are the ultimate choice for any challenging garden task. From cutting and collecting grass to mulching and fertilising. Discover how easy big lawn care can be.

## Being a STIGA lawn tractor



### EXCELLENT CUTTING

All tractors offer excellent cutting-performance, whatever the grass conditions. Thick, overgrown and damp grass can be quickly and efficiently cut and collected or rear-discharged. A mulch-kit comes as standard with every model.



### POWER AND CONTROL

All tractors are powered by high-performance twin- and single-cylinder engines. Efficiency, component-quality and reliability are the main attributes of all the engines chosen to power STIGA machines.



### ROBUST AND STURDY

All tractors are constructed around a highly robust chassis. Some models feature a reinforced heavy-duty deck; while others benefit from a cast-iron front axle that contributes further to overall strength and durability.

## ADDITIONAL FEATURES

### MAXIMUM CONTROL

Four-wheel drive traction allows to have improved grip on sloping and uneven terrains, while cruise control makes speed management easier.

### PEDAL OPERATED HYDROSTATIC TRANSMISSION

With no gears to operate, hands remain comfortably on the steering wheel for less tiring and safer cutting sessions.

### CUTTING WIDTH UP TO 122 CM

Wide and reinforced cutting decks prevent blockages, even with wet and tall grass. Featuring timed blades and anti-scalp wheels, they can be set up to 9 different cutting positions.

### INTUITIVE DASHBOARD

All operating information can be checked from the 6-LED or smart 5.5" widescreen display, also featuring Best Cutting Zone function. Blade engagement is button-operated and easy.

### WORK IN COMFORT

STIGA Comfort Plus Seat is fully adjustable and equipped with high back support and armrests.

The soft and ergonomic steering wheel offers optimal grip while the ABS panel absorbs vibrations at foot level.

# e-RIDE

STIGA e-Ride is the very first generation battery-powered tractors, completely designed, developed and produced by STIGA.

An electric tractor offers the same performance as a petrol-powered one, but without all the maintenance connected to being petrol-powered: no refueling, no oil to drain, no spark plugs to replace.

You just need to recharge the battery and off you go!



Recharge plug under the seat

Electric transmission for extremely silent and smooth power delivery

LED headlights for safe operations in poor light conditions



IP65, water protection for motors and electric system allows easy cleaning



2 Electric blade motors, 1,5 kW per blade ensure the highest cutting efficiency & performance

Battery-powered motor grants lower sound levels and low vibration

## BATTERY

- Premium battery cells with STIGA layout
- High durability, no memory effect
- Good air circulation between cells and low stress for the cells' life
- No stressed cells means longer service life

## ELECTRIC BLADE MOTORS

- Reduced maintenance, thanks to brushless DC motors mounted directly on the cutting deck, with no need of pulley or belt
- Efficiency up to 85% - no loss of power means higher runtime
- Maximum power & cutting performance in heavy load conditions
- 100% electric means noise reduction and better sound quality

## STIGA ELECTRIC TRANSMISSION

- Top-level usability is given by digitally controlled electric motor transmission
- Maneuvering precision
- Possibility to climb up to 10° slope

## STIGA.GO APP

STIGA connectivity on the e-Ride offers advanced features for an enhanced mowing and an easier life.

The machine connects to a smartphone thanks to Bluetooth communication.

The STIGA.GO mobile app allows you to:

The STIGA.GO mobile APP allows you to:

- See all information about your e-Ride, including the amount of CO2 saved from the beginning
- Schedule charging day and time with 2 possible sessions, in order to save costs
- Use the virtual dashboard while cutting (on e-Ride C500 and S500)
- See scheduled maintenance activities and add extra-activities if needed
- Contact your selected dealer and share the status of the machine with him with just one tap

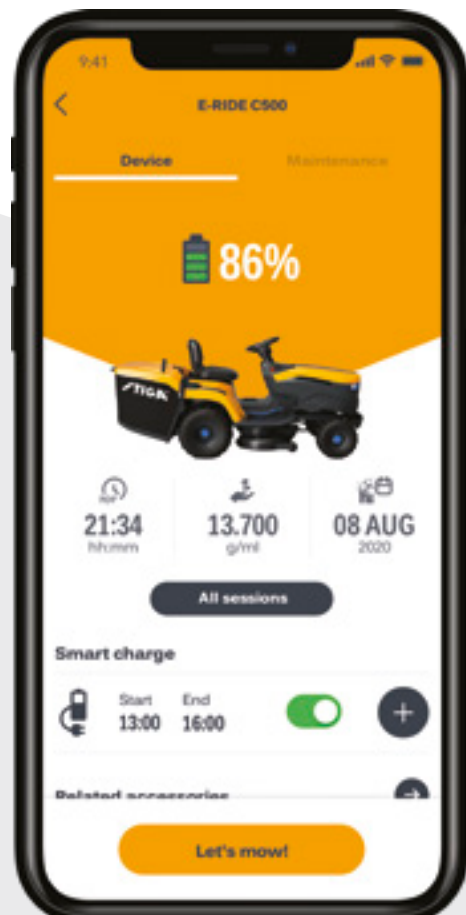

# e-Ride

Battery powered performance

A close-up photograph of the front of a STIGA lawn mower. The image shows a bright yellow plastic housing on the left, which houses a clear headlight assembly with multiple lenses. To the right, a black plastic component features the 'STIGA' logo in a silver, embossed font. Below the logo is a black plastic grille with a pattern of small circular holes. The background is a blurred green lawn.

STIGA

## E-RIDE C500

- Battery powered petrol-free and stress-free riding mower
- Cutting-edge and feature-packed – quick start, eco mode, cruise control, LED headlights and more
- 240l grass collector and mulching plug
- Powerful 1.2kW transaxle motor, and two cutting blade motors totalling 3kW
- 84cm cutting width, adjustable to 7 different heights
- 48V 40Ah battery included – standard charger included, fast charger available as optional accessory



BATTERY	E-RIDE C500	E-RIDE S500	E-RIDE C300	E-RIDE S300
Level	EXPERIENCE	EXPERIENCE	ESSENTIAL	ESSENTIAL
Series	500 Series	500 Series	300 series	300 series
Power source	Lithium-ion battery	Lithium-ion battery	Lithium-ion battery	Lithium-ion battery
Battery capacity	40 Ah	40 Ah	30 Ah	30 Ah
Rated power (kW@rpm)	3 kW @ 3200 rpm	3 kW @ 3200 rpm	3 kW @ 3200 rpm	3 kW @ 3200 rpm
Charging time	8 h	8 h	6 h	6 h
Charging system	External charger	External charger	External charger	External charger
Maximum working area	3000 m <sup>2</sup>	3000 m <sup>2</sup>	1800 m <sup>2</sup>	1800 m <sup>2</sup>
Cutting method	Collecting	Side discharge	Collecting	Side discharge
Cutting height positions	7 positions	7 positions	7 positions	7 positions
Cutting height range	25 - 80 mm	25 - 80 mm	25 - 80 mm	25 - 80 mm
Blade type	Winged	Mulching	Winged	Mulching
Blade engagement type	Electric	Electric	Electric	Electric
Transmission type	Electric	Electric	Electric	Electric
Transmission method	Pedal-operated	Pedal-operated	Pedal-operated	Pedal-operated
Collector capacity	240 L	-	240 L	-
Dashboard	Yes with LED	Yes with LED	Yes with LED	Yes with LED
Front wheel size	15x6.00-6	15x6.00-6	15x6.00-6	15x6.00-6
Rear wheel size	18x8.50-8	18x8.50-8	18x8.50-8	18x8.50-8
Headlights	Led	Led	Led	Led
Cruise control	Yes	Yes	No	No
App connectivity option	Yes	Yes	No	No
Washing link	Yes	Yes	Yes	Yes
Mulching kit	Included	Included	Included	Included
Battery charger	Single standard	Single standard	Single standard	Single standard
Art.-Nr.	2T2205481/ST1	2T0665481/ST1	2T2200481/ST1	2T0660481/ST1
Warranty	3-Years*	3-Years*	3-Years*	3-Years*

\*Terms & conditions apply

- Fast charger for e-Ride 278131808/ST1

# Estate

## The collecting hero

From compact and easy to manage domestic-use machines, through to powerful, robust, fast-working commercial-duty models, STIGA's Estate line-up includes a garden tractor to meet every requirement and every budget!

All STIGA Estate garden tractors are three-in-one machines capable of either collecting, rear-discharging or mulching clippings, which in turn means they can handle long grass, short grass and everything in between.

- **Extreme cutting precision**
- **Powerful engines**
- **Robust structure**
- **Mulching function available as standard**
- **Smart widescreen 5.5" display**
- **LED lights**
- **A wide range of accessories and attachments ensures great versatility, making Estate an all-season-machine**

### PRODUCT HERO

#### ESTATE PRO 9102 XWSY



## ESTATE PRO 9122 XWSY

**STIGA**  
**EXPERT**

- High-performance Honda twin-cylinder engine
- 122 cm reinforced cutting deck with 4 anti-scalp wheels
- 4WD ensures superb traction on any terrain
- Smart 5.5" widescreen display with all operating information and Best Cutting Zone
- Powerful LED headlights and robust front bumper
- Improved comfort seat with armrests and soft-grip steering wheel



PETROL	ESTATE PRO 9122 XWSY	ESTATE PRO 9102 XWSY	ESTATE 7122 HWSY	ESTATE 7102 HWSY
Level	<b>EXPERT</b>	<b>EXPERT</b>	<b>EXPERT</b>	<b>EXPERT</b>
Power source	Petrol	Petrol	Petrol	Petrol
Power	13.5 kW	12.65 kW	<b>13.4 kW</b>	<b>12.6 kW</b>
Engine Brand	Honda	Honda	Honda	Honda
Engine model	GXV 690	GXV 690	GXV 630	GXV 630
Displacement	688 cc	688 cc	688 cc	688 cc
Engine rotation speed	2700 rpm	2500 rpm	2700 rpm	2500 rpm
Fuel tank capacity	10 L	10 L	8 L	8 L
Maximum working area	9000 m <sup>2</sup>	8500 m <sup>2</sup>	8000 m <sup>2</sup>	7000 m <sup>2</sup>
Cutting method	Collecting	Collecting	Collecting	Collecting
Cutting width	122 cm	102 cm	122 cm	102 cm
Reinforced cutting deck	Yes	Yes	-	-
Cutting height positions	9 positions	9 positions	7 positions	7 positions
Cutting height range	25 - 100 mm	25 - 100 mm	30 - 90 mm	30 - 90 mm
Blade engagement type	Electric	Electric	Electric	Electric
Transmission type	Hydrostatic	Hydrostatic	Hydrostatic	Hydrostatic
Transmission method	Pedal-operated	Pedal-operated	Pedal-operated	Pedal-operated
Collector capacity	360 L	360 L	320 L	320 L
Dashboard	Yes with smart widescreen display	Yes with smart widescreen display	Yes with smart widescreen display	Yes with smart widescreen display
Front wheel size	16x6.00-8	16x6.00-8	15x6.00-6	15x6.00-6
Rear wheel size	20x10.00-10	20x10.00-10	18x8.50-8	18x8.50-8
Headlights	Led	Led	Led	Led
Cruise control	Yes	Yes	Yes	Yes
Cast iron front axle	-	-	Yes	Yes
Washing link	Yes	Yes	Yes	Yes
Mulching kit	Included	Included	Included	Included
Battery charger	Single standard	Single standard	Single standard	Single standard
Trailer hitch kit	Included	Included	Included	Included
Product weight	300 kg	295 kg	249 kg	246 kg
Art.-Nr.	2T1535381/ST1	2T1430381/ST1	2T1310381/ST1	2T0980381/ST1
Warranty	<b>5-Years* Domestic 1-Year Commercial</b>	<b>5-Years* Domestic 1-Year Commercial</b>	<b>5-Years*</b>	<b>5-Years*</b>

\*Terms & conditions apply

## ESTATE 5092 HW

**STIGA**  
EXPERIENCE

- Powerful and reliable STIGA ST 650 twin-cylinder engine
- Expansive 102 cm cutting deck with timed blades
- Large 290 L grass collector
- LED lights for great visibility of working area
- Durable and strong, thanks to cast-iron front axle
- Mulching kit included



PETROL	ESTATE 5102 HW	ESTATE 5092 HW	ESTATE 4092 H	ESTATE 3398 HW
Level	EXPERIENCE	EXPERIENCE	EXPERIENCE	EXPERIENCE
Power source	Petrol	Petrol	Petrol	Petrol
Power	9.7 kW	11.2 kW	7.9 kW	9.4 kW
Engine Brand	Honda	STIGA	STIGA	Honda
Engine model	GCV 530	ST 600 Twin Powered by STIGA	ST 500 Powered by STIGA	GCV 530
Displacement	530 cc	586 cc	452 cc	530 cc
Engine rotation speed	2700 rpm	2700 rpm	2600 rpm	2600 rpm
Fuel tank capacity	6 L	6 L	6 L	9 L
Maximum working area	5500 m <sup>2</sup>	4500 m <sup>2</sup>	4000 m <sup>2</sup>	4500 m <sup>2</sup>
Cutting method	Collecting	Collecting	Collecting	Collecting
Cutting width	102 cm	92 cm	92 cm	98 cm
Reinforced cutting deck	-	-	-	-
Cutting height positions	7 positions	7 positions	7 positions	7 positions
Cutting height range	25 - 80 mm	25 - 80 mm	25 - 80 mm	25 - 80 mm
Blade engagement type	Electric	Electric	Electric	Electric
Transmission type	Hydrostatic	Hydrostatic	Hydrostatic	Hydrostatic
Transmission method	Pedal-operated	Pedal-operated	Pedal-operated	Pedal-operated
Collector capacity	290 L	290 L	290 L	240 L
Dashboard	Yes with LED	Yes with LED	Yes with LED	Yes with LED
Front wheel size	15x6.00-6	15x6.00-6	15x6.00-6	15x6.00-6
Rear wheel size	18x8.50-8	18x8.50-8	18x8.50-8	18x8.50-8
Headlights	Led	Led	Led	Led
Cruise control	-	-	-	-
Cast iron front axle	-	-	-	Yes
Washing link	Yes	Yes	Yes	Yes
Mulching kit	Included	Included	Included	Included
Battery charger	Single standard	Single standard	Single standard	Single standard
Trailer hitch kit	Included	Included	Included	Included
Product weight	225 kg	219 kg	215 kg	167 kg
Art.-Nr.	2T1710381/ST1	2T0450481/ST1	2T0430481/ST1	2T2600381/ST1
Warranty	5-Years*	5-Years*	5-Years*	5-Years*

\*Terms & conditions apply



## ESTATE 2398 HW

**STIGA**  
ESSENTIAL

- Powerful, equipped with the STIGA twin-cylinder engine
- 98 cm wide cutting deck, for great collection, rear-discharge and mulching
- Large 240 L grass collector
- Seven available pre-set cutting heights to adapt to your lawn's needs
- Headlights for great visibility of working area
- Mulching plug included



PETROL	ESTATE 2398 HW	ESTATE 3098 H	ESTATE 3084 H	ESTATE 2084 H	ESTATE 2084
Level	ESSENTIAL	ESSENTIAL	ESSENTIAL	ESSENTIAL	ESSENTIAL
Power source	Petrol	Petrol	Petrol	Petrol	Petrol
Power	10.4 kW	8.6 kW	5.8 kW	<b>7.4 kW</b>	<b>5.8 kW</b>
Engine Brand	STIGA	Briggs & Stratton	Briggs & Stratton	STIGA	STIGA
Engine model	ST 550 Twin Powered by STIGA	PowerBuilt 4165 AVS	PowerBuilt 3130 AVS	ST 500 Powered by STIGA	ST 350 Powered by STIGA
Displacement	586 cc	500 cc	344 cc	452 cc	352 cc
Engine rotation speed	2600 rpm	2600 rpm	2400 rpm	2400 rpm	2400 rpm
Fuel tank capacity	6 L	6 L	6 L	6 L	6 L
Maximum working area	4500 m <sup>2</sup>	4000 m <sup>2</sup>	3500 m <sup>2</sup>	3500 m <sup>2</sup>	3000 m <sup>2</sup>
Cutting method	Collecting	Collecting	Collecting	Collecting	Collecting
Cutting width	98 cm	98 cm	84 cm	84 cm	84 cm
Reinforced cutting deck	-	-	-	-	-
Cutting height positions	7 positions	7 positions	7 positions	7 positions	7 positions
Cutting height range	25 - 80 mm	25 - 80 mm	25 - 80 mm	25 - 80 mm	25 - 80 mm
Blade engagement type	Electric	Electric	Electric	Electric	Electric
Transmission type	Hydrostatic	Hydrostatic	Hydrostatic	Hydrostatic	Mechanical
Transmission method	Pedal-operated	Pedal-operated	Pedal-operated	Pedal-operated	Lever-operated
Collector capacity	240 L	240 L	240 L	240 L	200 L
Dashboard	Yes with LED	Yes with LED	Yes with LED	Yes with LED	Yes with LED
Front wheel size	15x6.00-6	15x6.00-6	15x6.00-6	15x6.00-6	15x6.00-6
Rear wheel size	18x8.50-8	18x8.50-8	18x8.50-8	18x8.50-8	18x8.50-8
Headlights	Conventional	Led	Led	Conventional	Conventional
Cruise control	-	-	-	-	-
Cast iron front axle	-	Yes	Yes	-	-
Washing link	Yes	Yes	Yes	Yes	Yes
Mulching kit	Included	Included	Included	Included	Included
Battery charger	Single standard	Single standard	Single standard	Single standard	Single standard
Trailer hitch kit	Optional	Included	Included	Optional	Optional
Product weight	165 kg	165 kg	168 kg	165 kg	163 kg
Art.-Nr.	2T2630481/ST1	2T2620281/ST1	2T2110281/ST1	2T2120481/ST1	2T2000481/ST2
Warranty	3-Years*	5-Years*	5-Years*	3-Years*	3-Years*

\*Terms & conditions apply

# Tornado

## No lawn is impossible

STIGA Tornado garden-tractors are powerful, heavy-duty machines designed to meet the needs of both hardworking professional landscapers and exacting domestic gardeners!

Their dedicated side-discharge design saves time by eliminating the need for collection and ensures they'll take the sort of overgrown grass found in meadows and outlying informal areas in their stride.

- **Powerful engines**
- **Highest cutting performances**
- **Solid framework**
- **Comfortable seat and soft-grip steering wheel**
- **Mulching function available as standard**
- **Smart widescreen 5.5" display (on selected models)**
- **LED lights**
- **No box to empty**
- **A wide range of accessories and attachments ensures great versatility, making Tornado an all-season-machine**

### PRODUCT HERO

#### TORNADO PRO 9121 XWSY



## TORNADO PRO 9121 XWSY

**STIGA**  
**EXPERT**

- High-performance Honda twin-cylinder engine
- 121 cm reinforced cutting deck with 6 anti-scalp wheels
- LED display with all operating information and Best Cutting Zone
- Powerful LED headlights and robust front bumper
- Comfort is improved by seat with armrests and soft-grip steering wheel
- Cruise control ensures stress-less driving



PETROL	TORNADO PRO 9121 XWSY	TORNADO 7121 HWSY	TORNADO 6108 HW	TORNADO 3108 HW
Level	<b>EXPERT</b>	<b>EXPERT</b>	EXPERIENCE	EXPERIENCE
Power source	Petrol	Petrol	Petrol	Petrol
Power	13.5 kW	13.4 kW	12.1 kW	10 kW
Engine Brand	Honda	Honda	STIGA	Honda
Engine model	GXV 690	GXV 630	ST 650 Twin Powered by STIGA	GCV 530
Displacement	688 cc	688 cc	635 cc	530 cc
Engine rotation speed	2700 rpm	2700 rpm	2700 rpm	2800 rpm
Fuel tank capacity	15 L	15 L	15 L	9 L
Maximum working area	9000 m <sup>2</sup>	8500 m <sup>2</sup>	7000 m <sup>2</sup>	7000 m <sup>2</sup>
Cutting method	Side discharge	Side discharge	Side discharge	Side discharge
Cutting width	121 cm	121 cm	108 cm	108 cm
Reinforced cutting deck	Yes	Yes	-	-
Cutting height positions	9 positions	7 positions	7 positions	7 positions
Cutting height range	25 - 100 mm	30 - 90 mm	30 - 90 mm	25 - 80 mm
Blade engagement type	Electric	Electric	Electric	Electric
Transmission type	Hydrostatic	Hydrostatic	Hydrostatic	Hydrostatic
Transmission method	Pedal-operated	Pedal-operated	Pedal-operated	Pedal-operated
Dashboard	Yes with smart widescreen display	Yes with smart widescreen display	Yes with multifunctional display	-
Front wheel size	16x6.00-8	16x6.00-8	15x6.00-6	15x5.00-6
Rear wheel size	20x10.00-10	20x10.00-10	20x10.00-10	20x10.00-10
Headlights	Led	Led	Led	Led
Cruise control	Yes	Yes	-	-
Cast iron front axle	-	Yes	Yes	Yes
Washing link	Yes	Yes	Yes	Yes
Mulching kit	Included	Included	Included	Included
Battery charger	Single standard	Single standard	Single standard	Single standard
Trailer hitch kit	Included	Included	Included	Included
Product weight	297 kg	250 kg	229 kg	180 kg
Art.-Nr.	2T3040381/ST1	2T1945381/ST1	2T1845481/ST1	2T1200381/ST1
Warranty	5-Years* Domestic 1-Year Commercial	5-Years*	5-Years*	5-Years*

\*Terms & conditions apply



## TORNADO 2108 HW

**STIGA**  
ESSENTIAL

- Powerful, equipped with the STIGA twin-cylinder engine
- Stress-less driving with foot-pedal hydrostatic drive
- 20" rear wheels for high-grip traction
- Comfortable STIGA classic seat
- Headlights for great visibility of working area
- Cleaning nozzle for easy washing of the deck



PETROL	TORNADO 2108 HW	TORNADO 2098 H	TORNADO 2098
Level	ESSENTIAL	ESSENTIAL	ESSENTIAL
Power source	Petrol	Petrol	Petrol
Power	10.8 kW	8.4 kW	6.5 kW
Engine Brand	STIGA	STIGA	STIGA
Engine model	ST 550 Twin Powered by STIGA	ST 500 Powered by STIGA	ST 350 Powered by STIGA
Displacement	586 cc	452 cc	352 cc
Engine rotation speed	2800 rpm	2800 rpm	2800 rpm
Fuel tank capacity	6 L	6 L	6 L
Maximum working area	7000 m <sup>2</sup>	5000 m <sup>2</sup>	4500 m <sup>2</sup>
Cutting method	Side discharge	Side discharge	Side discharge
Cutting width	108 cm	98 cm	98 cm
Cutting height positions	7 positions	7 positions	7 positions
Cutting height range	25 - 80 mm	25 - 80 mm	25 - 80 mm
Blade engagement type	Electric	Electric	Electric
Transmission type	Hydrostatic	Hydrostatic	Mechanical
Transmission method	Pedal-operated	Pedal-operated	Lever-operated
Dashboard	-	-	-
Front wheel size	15x6.00-6	15x6.00-6	15x6.00-6
Rear wheel size	20x10.00-10	18x8.50-8	18x8.50-8
Headlights	Conventional	Conventional	Conventional
Cruise control	-	-	-
Washing link	Yes	Yes	Yes
Mulching kit	Included	Included	Included
Battery charger	Single standard	Single standard	Single standard
Trailer hitch kit	Optional	Optional	Optional
Product weight	176 kg	157 kg	160 kg
Art.-Nr.	2T1220481/ST1	2T0630481/ST1	2T0510481/ST2
Warranty	3-Years*	3-Years*	3-Years*

\*Terms & conditions apply

# Combi

## The small garden conqueror

Thanks to its compact dimensions and excellent maneuverability, a Combi ride-on is the perfect choice for taking care of smaller lawns where there are obstacles and complex borders to negotiate.

- **Full, unrestricted view of the working area**
- **Three cutting-methods available: collection, side discharge, mulching**
- **The ideal upgrade from a larger walk-behind mower**
- **Ease of use**

### PRODUCT HERO COMBI 1066 HQ



## COMBI 1066 HQ

**STIGA**  
ESSENTIAL

- Powered by a STIGA 224cc single cylinder engine
- Compact and highly manoeuvrable
- Easy-to-reach speed variator and smooth speed control
- 3-in-1 cutting system: collection, side discharge and mulching
- Spacious 150l grass collector
- 66cm cutting width, adjustable to different heights



PETROL	COMBI 2072 H	COMBI 1066 HQ
Level	EXPERIENCE	ESSENTIAL
Power source	Petrol	Petrol
Power	7.1 kW	3.6kW
Enginge Brand	STIGA	STIGA
Enginge model	ST 400 Powered by STIGA	ST 250 ES Powered by STIGA
Displacement	414 cc	224 cc
Engine rotation speed	2800 rpm	2450 rpm
Fuel tank capacity	4 L	3.8 L
Maximum working area	2500 m <sup>2</sup>	1500 m <sup>2</sup>
Cutting method	Collecting	Collecting, Side discharge
Cutting width	72 cm	66 cm
Cutting height positions	7 positions	6 positions
Cutting height range	30 - 80 mm	30 - 76 mm
Blade engagement type	Manual	Manual
Transmission type	Hydrostatic	Hydrostatic
Transmission method	Lever-operated	Pedal-operated
Collector capacity	170 L	150 L
Dashboard	Yes with LED	-
Front wheel size	11x4.00-4	13x5.00-6
Rear wheel size	15x6.00-6	15x6.00-6
Headlights	Conventional	-
Cruise control	-	-
Washing link	Yes	Yes
Mulching kit	Included	Included
Battery charger	Single standard	Single standard
Trailer hitch kit	-	-
Product weight	162 kg	131 kg
Art.-Nr.	2T0210481/ST1	2T0070481/ST1
Warranty	2-Years	2-Years

# Accessories and attachments

## LAWN TRACTORS ESTATE

Product name	Art. N.	Pos	Estate Pro	Estate Pro	Estate	Estate	Estate	Estate 5092 HW	Estate 3398 HW	Estate 3084 H	E-Ride C300
			9122 XWSY	9102 XWSY	7122 HWSY	7102 HWSY	5102 HW	Estate 4092 H	Estate 3098 H	Estate 2084 H	E-Ride S500
STIGA Protective Cover	1134-9177-01	1	•	•	•	•	•	•	•	•	•
Trailer Hitch	299900395/0	22									
Trailer Hitch	299900081/0	23									
Trailer Hitch	299901081/0	24									
Trailer Hitch	299900006/0	25			•	•					
Trailer Hitch	210000000/17	26									
Trailer Hitch	299901006/0	26	•	•							
Rear Deflector	299900310/0	n.a.									
Rear Deflector	299900051/0	16									
Rear Deflector	299900016/0	16	•	•	•	•					
Mulching Kit (plug)	299900038/0	28									
Mulching Kit (plug)	299900045/0	29									
Mulching Kit (plug)	299900055/0	30				•					
Mulching Kit (plug)	299900046/0	36			•						
Mulching Kit (plug)	299901055/0	31		•							
Mulching Kit (plug)	299901056/0	32	•								
Mulching Kit (plug and blades)	299900370/1	37									
Mulching Kit (plug and blades)	299900374/0	38									
Mulching Kit (plug and blades)	299900070/0	39									
Mulching Kit (plug and blades)	299900073/0	40									
Mulching Kit (plug and blades)	299900074/0	41									
Mulching Kit (plug and blades)	299900076/0	42			•						
Mulching Kit (plug and blades)	210330000/17	45									
Mulching Kit (plug and blades)	299901074/0	41		•							
Mulching Kit (plug and blades)	299901077/0	43	•								
Combi Cart	13-0952-11	2	•	•	•	•	•	•	•	•	•
Fertiliser Spreader	13-0955-11	3	•	•	•	•	•	•	•	•	•
Sand Spreader	13-1975-14	9	••••	••••							
Poly Roller 23"	299900260/0	10	•	•	•	•	•	•	•	•	•
Poly Roller 36"	210800100/18	10	•	•	•	•	•	•	•	•	•
Rear Weight	299900150/0	17	•	•	•	•	•	•	•	•	•
Winter Tyres 18"	299900430/0	11			•	•	•	•	•	•	•
Winter Tyres 20"	211500000/18	12	•	•							
Snow Chain 18"	299900470/1	13			•	•	•	•	•	•	•
Snow Chain 20"	299900480/1	13	•	•							
Snow Tyre Spikes	299900450/0	14	•	•	•	•	•	•	•	•	•
Snow Blade 107 cm	299903410/1	15									
Snow Blade 120 cm	299900400/0	15			•	•					
Snow Blade 120 cm	299900405/0	15									
Snow Blade 120 cm MCS	299900400/1	15			•	•	•	•			
Snow Blade 125 cm MCS	211300100/17	15	•	•							
PTO Kit MCS	299900750/1	19			•	•	•	••			
PTO Kit MCS	211000100/17	20	•	•							
Sweeper 105 cm MCS	299900500/1	7			•••	•••	•••	•••			
Sweeper 120 cm MCS	211200100/17	8	•	•							
Green Keeper 110 cm MCS	211900100/17	6	•	•							
Flail Mower 105 cm MCS	299900540/0	4			•	•					
Lawn Striping Kit	212120000/18	21	•	•							
Fast Charger for E-Ride	278131808/ST1										•

MCS: Multi-Connect System

- Adapter for Estate 5-4 Series (when using PTO 299900750/1) 299900800/0
- Front rubber for sweeper 299900505/1
- Need to order the cable 182040074/0 (Availability and price in definition)



## LAWN TRACTORS TORNADO

Product name	Art. N.	Pos	Tornado Pro 9121 XWSY	Tornado 7121 HWSY	Tornado 6108 HW	Tornado 3108 HW Tornado 2108 HW	Tornado 2098 H Tornado 2098	E-Ride S300 E-Ride S500
STIGA Protective Cover	1134-9177-01	1	•	•	•	•	•	•
Trailer Hitch	21000000/17	26	•	•	•			
Trailer Hitch	299900385/0	27				•	•	
Mulching Kit (plug)	299900341/0	35					•	•
Mulching Kit (plug)	299900346/0	36				•		
Mulching Kit (plug)	299900135/0	33						
Mulching Kit (plug)	299900036/0	34						
Mulching Kit (plug and blades)	299900037/0	44						
Mulching Kit (plug and blades)	210330000/17	45			•			
Mulching Kit (plug and blades)	210300000/17	46	•	•				
Combi Cart	13-0952-11	2	•	•	•	•	•	
Grass and leaves Collector 42" Compact	2A6107010/S17	5	•	•	•	•	•	
Fertiliser Spreader	13-0955-11	3	•	•	•	•	•	
Sand Spreader	13-1975-14	9	••••					
Poly Roller 23"	299900260/0	10	•	•	•	•	•	
Poly Roller 36"	210800100/18	10	•	•	•	•	•	
Rear Weight	210900100/17	18	•	•	•			
Winter Tyres 18"	299900430/0	11				•	•	
Winter Tyres 20"	211500000/18	12	•	•	•	•		
Snow Chain 18"	299900470/1	13					•	
Snow Chain 20"	299900480/1	13	•	•	•			
Snow Tyre Spikes	299900450/0	14	•	•	•	•	•	
Snow Blade 107 cm	299903410/1	15				•	•	
Snow Blade 120 cm	299900400/0	15		•	•			
Snow Blade 120 cm	299900405/0	15						
Snow Blade 120 cm MCS	299900400/1	15		•	•			
Snow Blade 125 cm MCS	211300100/17	15	•					
PTO Kit MCS	299900750/1	19		•	•			
PTO Kit MCS	211000100/17	20	•					
Sweeper 105 cm MCS	299900500/1	7		•••	•••			
Sweeper 120 cm MCS	211200100/17	8	•					
Green Keeper 110 cm MCS	211900100/17	6	•					
Flail Mower 105 cm MCS	299900540/0	4		•	•			
Fast Charger for E-Ride	278131808/ST1							•

MCS: Multi-Connect System

- Adapter for Estate 5-4 Series (when using PTO 299900750/1) 299900800/0
- Front rubber for sweeper 299900505/1
- Need to order the cable 182040074/0 (Availability and price in definition)

## LAWN TRACTORS COMBI

Product name	Art. N.	Pos	Combi 2072 H	Combi 1066 HQ
STIGA Protective Cover	1134-9177-01	1	•	•
Mulching Kit (Plug)	299900135/0	33		•
Mulching Kit (Plug)	299900036/0	34	•	
Mulching Kit (plug and blades)	299900037/0	44	•	



**1**  
STIGA protective cover



**2**  
Combi cart



**3**  
Fertiliser spreader



**4**  
Flail mower



**5**  
Grass and leaves collector



**6**  
Green keeper



**7**  
Sweeper



**8**  
Sweeper



**9**  
Sand spreader



**10**  
Poly roller



**11 - 12**  
Winter tires



**13**  
Snow chain



**14**  
Snow tyres spikes



**15**  
Snow blade



**16**  
Rear deflector



**17**  
Rear weight



**18**  
Rear weight



**19**  
PTO kit



**20**  
PTO kit



**21**  
Lawn striping kit



22 - 23 - 24 - 25 - 26 - 27  
Trailer hitch



28 - 29 - 30 - 31 - 32 - 33 - 34 - 35 - 36  
Mulching kit (plug)



37      38      39      40      41      42      43      44      45      46

Mulching kit (plug and blades)

## Multi-Connect System

The Multi-connect system enables you to switch between a wide choice of implements for spring, autumn, and winter use. Extremely versatile; switching accessories is quick and easy and requires no tools. Choose from a wide selection of implements, but please ensure you choose the correct Multi-connect system to suit your model (2WD or 4WD) or speak to your local STIGA dealer who will be happy to help.



+



### PTO KIT

Attached to the tractor it can be left in position even without using the implements itself.

# stig

Stig is a combination of fresh engineering and lawn cutting expertise collected by STIGA over many years. Designed and engineered from the inside-out to maintain your lawn to perfection. Stig is not just a mower – it is a new way of living .



Lightweight & compact:  
perfectly balanced for all  
terrain - slopes up to 45% (24°)



Simple, intuitive  
on-board control  
panel + App  
connectivity and  
control



Noise reduction  
built-in-robust shell  
constructed from a plastic  
consisting of polypropylene  
and 30% talc

High performance  
cutting by 4 pivoting  
blades



The highest safety  
levels - from front  
to back



## THE BODY

- Suitable for multiple garden types - up to 1200 sqm
- Compact – can tackle complex gardens and narrow spaces bypassing trees and bushes
- Lightweight - less than 8 kg
- Minimum Noise – the bottom cover is made from a material that absorbs and reduces noise
- Perfect balance – thanks to the design of the chassis the centre of gravity allows the robot to climb slopes up to 45% (24°)



## THE HEART

- High-quality battery, ensuring stunning performance and a long life
- 3 years performance (1500 charging and discharging cycles)
- Provides energy to brushless wheels & blade motors



## THE BRAIN

- Stig's brain has two hemispheres: one for power and the one for logic
- By setting up to 5 "Go-to-Cut" points, Stig will learn where to start the cutting sessions along the wire
- The rain sensor will ensure a correct recognition of rain and false humidity cases
- Soft obstacle detection sensors



## RELATIONSHIP WITH THE USER

The user interface is made of simple and intuitive functions:

- On/Off switch
- Start
- Go home
- Bluetooth activation/pairing
- Spot cut /scheduled cutting mode

## STIG APP

The new Stig App has been designed and developed by STIGA. It is both intuitive and easy to use, allowing you to communicate with Stig at anytime. Available on IOS and Android .

- Through the App you can
- schedule a cutting program
  - scheduled and spot cut
  - border cut
  - Go-To-Cut points
  - Eco-mode
  - set rain sensors



# STIG



- Mows up to 1200sqm (5Ah battery) or 600sqm (2.5Ah battery)
- Choose between scheduled cutting session or spot cut, if you need Stig to immediately start cutting
- Intuitive keypad and controls
- Obstacle sensors protect the whole family
- Bluetooth-enabled for smartphone control through the STIG app
- Powered by 5Ah or 2.5Ah battery – sold separately



BATTERY	STIG
Level	EXPERIENCE
Power source	Lithium-ion battery
Motor type	Brushless
Charging system	Automatic
Cutting method	Random
Cutting width	18 cm
Cutting height range	20 - 60 mm
Blade type	4 Pivoting blades
Blade speed	2850 rpm
Maximum cutting speed	24 m/m
Rain sensors	Yes
Maximum slope	45%
Smart APP	Yes
APP Control	Bluetooth
User interface	Keypad
APP lock	Yes
Obstacle detection sensors	Yes
Product weight	7.2 kg
Art.-Nr.	2R3100018/ST1
Warranty	2-Years



BATTERY	POWER KIT E 1200	POWER KIT E 600
Battery capacity	5 Ah	2.5 Ah
Square meters	1200 m <sup>2</sup>	600 m <sup>2</sup>
Max working time	140 min	70 min
Charging time	100 min	100 min
Go-to-cut points	5	3
Eco mode	Yes	No
Product weight	0.4 kg	0.7 kg
Art.-Nr.	2R0102308/ST1	2R0101108/ST1
Warranty	2-Years	2-Years

Ask your local authorised STIG dealer for more details, all STIG dealers are authorised and trained to the highest standard with specialist software and tooling to install and take care of your STIG into the future.

# STIG ACCESSORIES

Code	EAN	Pos	Description	Fits for	Specification
1127-0012-01	7313324006751	-	Installation KIT Small	STIG	150 m - Ø 2.7 mm cable + 200 pegs + 5 fast connectors + 5 docking station connectors
1127-0013-01	7313324006768	-	Installation KIT Medium	STIG	300 m - Ø 2.7 mm cable + 400 pegs + 5 fast connectors + 5 docking station connectors
1127-0000-01	7313324006638	-	Cable reel 150 mt	STIG	Ø 2.7 mm - L 150 m
1127-0001-01	7313324006645	-	Cable reel 300 mt	STIG	Ø 2.7 mm - L 300 m
1127-0002-01	7313324006652	-	Cable reel 500 mt	STIG	Ø 3.4 mm - L 500 m
1127-0004-01	7313324006676	-	Fast connectors	STIG	5 pcs
1127-0005-01	7313324006683	-	Docking station connectors	STIG	5 pcs
1127-0006-01	7313324006690	-	Pegs (100 pcs)	STIG	100 pcs
1127-0008-01	7313324006713	-	Docking station pegs	STIG	8 pcs
1127-0009-01	7313324006720	-	Razors	STIG	Blister with 12 blades
1127-0010-01	7313324006737	-	Cable extension for charger	STIG	5 mt wire extension for charger
1127-0011-01	7313324006744	-	Docking station cover	STIG	n.a.

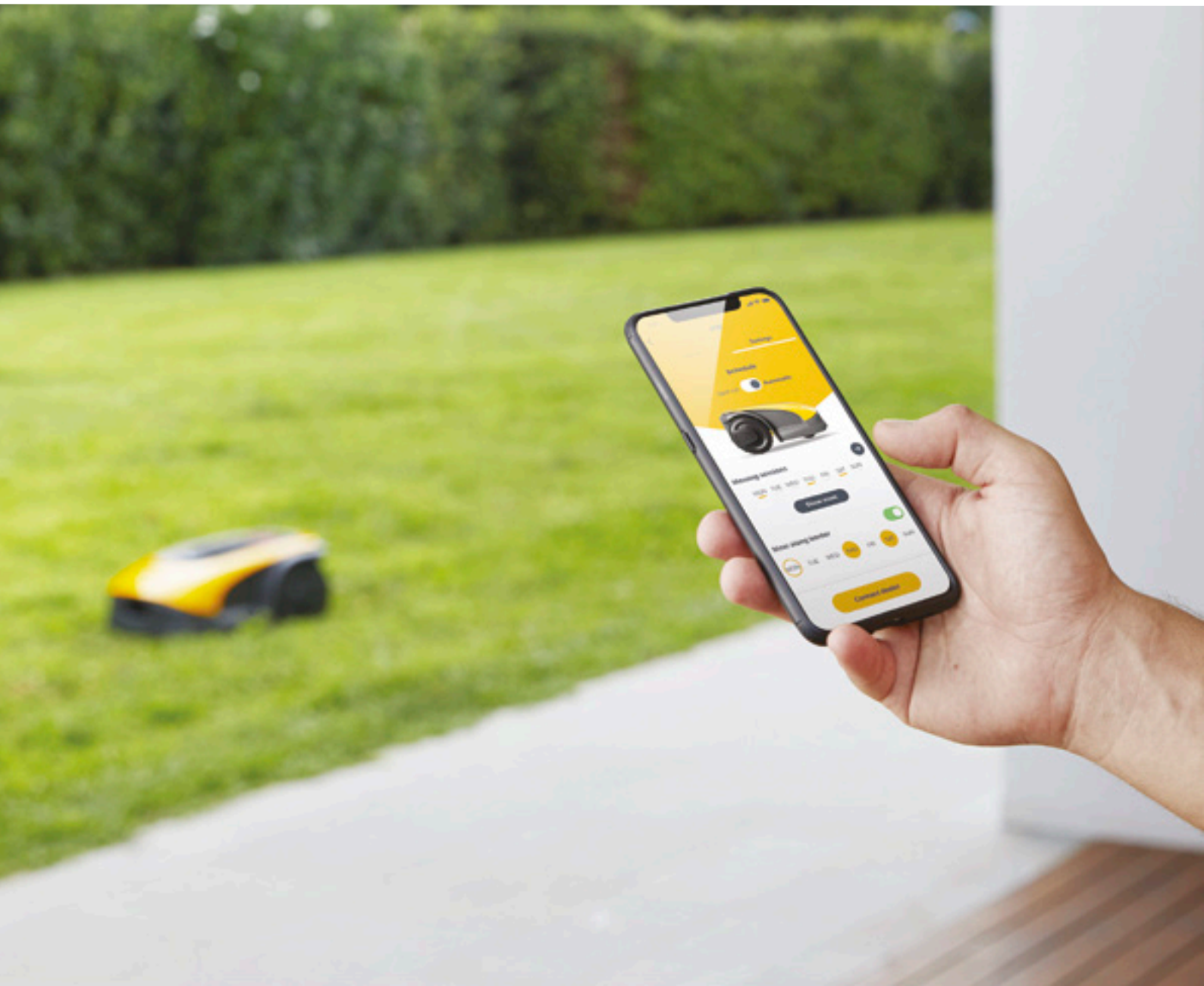

# Lawn Mowers

Twinclip, Multiclip, Combi & Collector





# A wide choice, for every type of garden

STIGA lawn mowers are easy to use, reliable and robust machines and this comprehensive range has been designed to meet every customer's lawn-care needs. Depending on the size of the garden, there is a variety of models to choose from, with different power sources and cutting systems: collecting, mulching and side discharge models, to suit all needs.

## Being a STIGA lawn mower



### TOP CUT PERFORMANCE

STIGA walk-behind lawn mowers offer an excellent mowing-experience and superior cutting-performance, through STIGA's patented dual-level Twinclip blade and STIGA's Multiclip technology. Four cutting-methods are available on these machines: collecting, mulching, side- and rear-discharge.

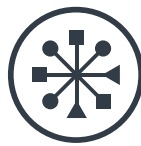

### A WIDE CHOICE

STIGA offers a wide selection of cutting-decks that vary in design and width. There's a deck-type to meet any lawn and any need!



### EQUIPPED FOR COMFORT

Available features - such as a Blade-Brake Clutch, an Anti-Vibration System and a grass-guard - make mowing easier and more enjoyable.

## ADDITIONAL FEATURES

### DIFFERENT POWER SOURCES

STIGA offers a wide choice of power sources, to suit all needs. Lawn mowers can be battery-, petrol- or electrically-powered.

### CAPACIOUS GRASSBAGS

STIGA collector bags are available up to a capacity of 70L, ideal for longer cutting sessions.

### WIDE RANGE OF CUTTING HEIGHTS

Cutting heights are easy to adjust - and with such a wide range, there is a mower to suit everyone.

### ERGONOMIC AND SMART HANDLES

All STIGA handlebars are designed to enhance ergonomics and comfort. STIGA battery-powered lawn mowers feature a new intuitive keypad.

### DRIVING

Lawn mowers can be self-propelled, for long and demanding sessions on larger lawns, or push-propelled, for small and domestic gardens.

### ADDITIONAL COMFORT FEATURES

**Electric start:** start the engine with the push of a button. No cord to pull.

**Speed variator:** adjusts the drive speed to a comfortable pace.

**Vibration Control System:** reduces vibration with shock absorbing materials.

**Blade Brake Clutch:** disengages the blade while keeping the engine on.

**Washing link:** to easily clean the deck after use.

**Vertical storage:** to store it vertically with oil and fuel on board and occupies less space.

**Roller versions:** replace the back wheels with a rear steel roller for the perfectly striped English garden.

# Twinclip

Superior cutting for perfect lawn care

STIGA Twinclip lawn mowers offer superior cutting- and collecting- performance with maximum comfort and impressive endurance. All models feature a double-edged Twinclip blade, that doubles mowing-efficiency for the perfect finish.

- **Double-edged Twinclip blade**
- **Special deck design**
- **Improved airflow**
- **Strong chassis and hybrid deck**
- **Heavy-duty transmission**
- **One-motion system: collector bag, cutting height and handle adjustment can be managed with just one hand**
- **Comfort**



## TWINCLIP 55 SVEQ H

- Self-propelled lawnmower equipped with Honda engine with electric start
- 4 cutting modes available: collecting, mulching, rear- or side-discharge
- Centrally-adjusted cutting height, up to 7 positions available
- Easy speed management with speed regulator
- Resistant and reliable galvanized steel deck
- Vibration control system included



**STIGA**  
**EXPERT**

PETROL	TWINCLIP 55 SVEQ H	TWINCLIP 55 S H BBC	TWINCLIP 55 S-R H BBC	TWINCLIP 55 SV H
Level	<b>EXPERT</b>	<b>EXPERT</b>	<b>EXPERT</b>	<b>EXPERT</b>
Power source	Petrol	Petrol	Petrol	Petrol
Power	3.3 kW	2.8 kW	2.8 kW	3.3 kW
Enginge Brand	Honda	Honda	Honda	Honda
Enginge model	GCVxe170 OHV Autochoke	GXV 160 OHV	GXV 160 OHV	GCVx170 OHV Autochoke
Displacement	167 cc	163 cc	163 cc	167 cc
Engine rotation speed	2900 rpm	2800 rpm	2800 rpm	2900 rpm
RPM control	Fixed rpm	Accelerator on handlebar	Accelerator on handlebar	Fixed rpm
Fuel tank capacity	0.95 L	1.8 L	1.8 L	0.95 L
Engine Oil tank capacity	0.4 L	0.65 L	0.65 L	0.4 L
Maximum working area	2500 m <sup>2</sup>	2500 m <sup>2</sup>	2500 m <sup>2</sup>	2500 m <sup>2</sup>
Cutting method	Collecting, Mulching, Side discharge, Rear discharge	Collecting, Rear discharge	Collecting	Collecting, Mulching, Rear discharge
Cutting width	53 cm	53 cm	53 cm	53 cm
Deck material	Galvanized steel	Galvanized steel	Galvanized steel	Galvanized steel
Cutting height adjustment	Centralized	Centralized	Centralized	Centralized
Cutting height positions	7 positions	7 positions	8 positions	7 positions
Cutting height range	25 - 77 mm	25 - 77 mm	13 - 65 mm	25 - 77 mm
Driving	Self-propelled	Self-propelled	Self-propelled	Self-propelled
Speed variator	Yes	No	No	Yes
Collector capacity	70 L	70 L	80 L	70 L
Handlebar type	Ergonomic 25 mm adj. by button + soft grip	Ergonomic 25 mm adj. by button + soft grip	Ergonomic 25 mm adj. by button + soft grip	Sideral 28 mm adj. by lever + soft grip
Wheels	210/240 mm grooved wheels on ball bearings	210/240 mm grooved wheels on ball bearings	200/ROLLER grooved wheels on ball bearings	210/240 mm grooved alumi- num wheels on ball
Blade Brake Clutch (BBC)	No	Yes	Yes	-
Vibe Control System (VCS)	Yes	No	No	Yes
Washing link	Yes	Yes	Yes	Yes
Product weight	48 kg	55 kg	55 kg	48 kg
Art.-Nr.	294563538/ST1	294568038/ST1	294569338/ST1	294563038/ST1
Warranty	5-Years*	5-Years*	5-Years*	5-Years*

\*Terms & conditions apply

## TWINCLIP 50 S

- 166 cc STIGA petrol engine
- Self-propelled, pro alu transmission
- 48 cm cutting width
- 70 litre grass collector with grassbag full indicator
- Can also be used in rear discharge or mulching mode



**STIGA**  
**EXPERT**

PETROL	TWINCLIP 50 SVEQ B	TWINCLIP 50 SQ H	TWINCLIP 50 S
Level	<b>EXPERT</b>	<b>EXPERT</b>	<b>EXPERT</b>
Power source	Petrol	Petrol	Petrol
Power	2.59 kW	2.75 kW	2.6 kW
Enginge Brand	Briggs & Stratton	Honda	STIGA
Enginge model	B&S 675 iSi series InStart	GCVx145 OHV Autochoke	ST 170 OHV Autochoke
Displacement	163 cc	145 cc	166 cc
Engine rotation speed	2800 rpm	2900 rpm	2900 rpm
RPM control	Fixed rpm	Fixed rpm	Fixed rpm
Fuel tank capacity	1 L	0.95 L	1 L
Engine Oil tank capacity	0.47 l	0.4 l	0.55 l
Maximum working area	2000 m <sup>2</sup>	2000 m <sup>2</sup>	2000 m <sup>2</sup>
Cutting method	Collecting, Mulching, Side discharge, Rear discharge	Collecting, Mulching, Side discharge, Rear discharge	Collecting, Mulching, Rear discharge
Cutting width	48 cm	48 cm	48 cm
Deck material	Galvanized steel	Galvanized steel	Galvanized steel
Cutting height adjustment	Centralized	Centralized	Centralized
Cutting height positions	7 positions	7 positions	7 positions
Cutting height range	25 - 77 mm	25 - 77 mm	25 - 77 mm
Driving	Self-propelled	Self-propelled	Self-propelled
Speed variator	Yes	No	No
Collector capacity	70 L	70 L	70 L
Handlebar type	Ergonomic 25 mm adj. by button + soft grip	Ergonomic 25 mm adj. by button + soft grip	Ergonomic 25 mm adj. by button + soft grip
Wheels	210/240 mm grooved wheels on ball bearings	210/240 mm grooved wheels on ball bearings	210/240 mm grooved wheels on ball bearings
Blade Brake Clutch (BBC)	No	No	No
Vibe Control System (VCS)	Yes	Yes	No
Washing link	Yes	Yes	Yes
Product weight	43 kg	43 kg	41 kg
Art.-Nr.	294513528/ST2	294512838/ST1	294512048/ST1
Warranty	5-Years*	5-Years*	5-Years*

\*Terms & conditions apply

## TWINCLIP 950 SQ AE

- Powerful battery-powered self-propelled lawnmower
- Ultra-powerful 2.2kW brushless motor delivers efficient mowing
- Double-layered blade maximises bagging efficiency
- Intuitive keypad with eco mode and six different speeds
- Extremely resistant aluminium wheel caps and carrying handle

**EPower**  
DRIVEN BY STIGA



BATTERY	TWINCLIP 950 SQ AE
Level	<b>EXPERT</b>
Series	900 series
Power source	Lithium-ion battery
Battery Voltage	48 V
Recommended Battery (Batteries & charger NOT included)	2 x 7.5Ah
Run time	Up to 40 mins dependent on conditions
Maximum working area	1100 m <sup>2</sup>
Cutting method	Collecting, Mulching, Side discharge, Rear discharge
Cutting width	48 cm
Deck material	Galvanized steel
Cutting height adjustment	Centralized
Cutting height positions	7 positions
Cutting height range	25 - 77 mm
Eco-mode	Yes
Driving	Self-propelled
Speed variator	Yes electronic
Collector capacity	70 L
Handlebar type	Ergonomic 25 mm with keypad, double hand switch and cam locks + soft grip
Wheels	210/240 mm grooved aluminum wheels on ball bearings
Product weight	42 kg
Art.-Nr.	294513898/ST1
Warranty	2-Years



### XC SYSTEM TECHNOLOGY

**Double-layered blade** specifically shaped to perform a double cut and make grass clippings smaller

**Special deck design** improving the airflow and the overall collecting performances

**Extrashield** protecting mechanical parts against dirt and bumps



### ONE MOTION SYSTEM

**Plug-in-box** allows you to plug it with just one hand and in just one movement

**Button-handle system** to regulate to desired cutting height in just one movement

**Overinjected levers** to adjust the Pro handlebar in height by means of a single motion



### STRONG CONSTRUCTION

**Composite deck** mixing the resistance of galvanized steel with the durability of aluminium

**Stronger chassis** with four moulding steps to double the stiffness

# Combi & Collector

The perfect combination of performance and comfort

The Combi models are versatile lawn mowers offering 3 or 4 cutting-systems in one machine. The airflow under the deck has been designed to improve cutting results.

- **3 or 4 in 1 cutting methods: collecting, mulching, side or rear discharge**
- **Front handle**
- **Skid plate to improve grass collection**
- **Central cutting height adjustment**
- **Grass catcher with full box indicator**
- **Washing link for quick wash of the deck**
- **Available power source: petrol, battery and electric**



## COMBI 955 SQ AE

- Ultra-powerful 2.2kW motor delivers an exceptional cut and run time
- 53cm cutting width, 6 speeds, sturdy cutting heights, and 4-in-1 cutting system
- Electric brushless transmission means more efficient and comfortable mowing
- Hard plastic front protects from obstacle impacts
- Strong carrying handle and folding handlebar for easy storage



BATTERY	COMBI 955 SQ AE	COMBI 950 SQ AE
Level	<b>EXPERT</b>	<b>EXPERT</b>
Series	900 series	900 series
Power source	Lithium-ion battery	Lithium-ion battery
Battery Voltage	48 V	48 V
Recommended Battery (Batteries & charger NOT included)	2 x 7.5Ah	2 x 7.5Ah
Run time	Up to 35 mins dependent on conditions	Up to 45 mins dependent on conditions
Maximum working area	1000 m <sup>2</sup>	950 m <sup>2</sup>
Cutting method	Collecting, Mulching, Side discharge, Rear discharge	Collecting, Mulching, Side discharge, Rear discharge
Cutting width	53 cm	48 cm
Deck material	Galvanized steel	Galvanized steel
Cutting height adjustment	Centralized	Centralized
Cutting height positions	5 positions	5 positions
Cutting height range	25 - 80 mm	25 - 65 mm
Eco-mode	Yes	Yes
Driving	Self-propelled	Self-propelled
Speed variator	Yes electronic	Yes electronic
Collector capacity	70 L	70 L
Handlebar type	Ergonomic 25 mm with keypad, double hand switch and cam locks + soft grip	Ergonomic 25 mm with keypad, double hand switch and cam locks + soft grip
Wheels	200/280 mm grooved wheels on ball bearings with soft tread	180/240 mm grooved wheels on ball bearings with soft tread
Product weight	36 kg	33 kg
Art.-Nr.	294557898/ST1	294507898/ST1
Warranty	<b>2-Years</b>	<b>2-Years</b>





## COMBI 753 SQ AE

- Battery-powered lawn mower for fast, hassle-free cuts
- Extra-wide 51cm COMBI cutting deck with ultra-durable galvanised treatment
- Adjustable handlebar with keypad, including six speeds and eco mode
- Hybrid 60l grass catcher
- Extra-powerful 1.5 kW brushless motor



**EPower**  
DRIVEN BY STIGA

BATTERY	COMBI 753 SQ AE	COMBI 748 SQ AE	COMBI 748 Q AE
Level	EXPERIENCE	EXPERIENCE	EXPERIENCE
Series	700 series	700 series	700 series
Power source	Lithium-ion battery	Lithium-ion battery	Lithium-ion battery
Battery Voltage	48 V	48 V	48 V
Recommended Battery (Batteries & charger NOT included)	2 x 5Ah	2 x 4Ah	1 x 5Ah
Run time	Up to 25 mins dependent on conditions	Up to 25 mins dependent on conditions	Up to 20 mins dependent on conditions
Maximum working area	600 m <sup>2</sup>	550 m <sup>2</sup>	450 m <sup>2</sup>
Cutting method	Collecting, Mulching, Side discharge, Rear discharge	Collecting, Mulching, Side discharge, Rear discharge	Collecting, Mulching, Side discharge, Rear discharge
Cutting width	51 cm	46 cm	46 cm
Deck material	Galvanized steel	Galvanized steel	Galvanized steel
Cutting height adjustment	Centralized	Centralized	Centralized
Cutting height positions	6 positions	6 positions	6 positions
Cutting height range	22 - 80 mm	22 - 80 mm	22 - 80 mm
Eco-mode	Yes	Yes	Yes
Driving	Self-propelled	Self-propelled	Push
Speed variator	Yes electronic	Yes electronic	No
Collector capacity	60 L	60 L	60 L
Handlebar type	Ergonomic 25 mm with keypad, double hand switch and cam locks + soft grip	Ergonomic 25 mm with keypad, double hand switch and cam locks + soft grip	Ergonomic 25 mm with keypad, double hand switch and cam locks + soft grip
Wheels	200/280 mm grooved wheels on ball bearings with soft tread	200/280 mm grooved wheels on ball bearings with soft tread	200/280 mm grooved wheels on ball bearings with soft tread
Product weight	31 kg	29 kg	26 kg
Art.-Nr.	2L0537878/ST1	2L0487878/ST1	2L0485978/ST1
Warranty	2-Years	2-Years	2-Years

## COMBI 55 SQ DAE

- Cordless, battery powered mower with minimal noise & emissions
- 53 cm cutting width
- Centralised height of cut adjustable through 25 - 80 mm
- Digital display with electronic speed variator & eco-mode
- Large 70 litre grass collector
- Compatible with 500 series system lineup



**STIGA**  
EXPERT

**EPOWER**  
DRIVEN BY STIGA

PETROL	COMBI 55 SQ DAE	COMBI 50 SQ DAE	COMBI 48 SQ DAE	COMBI 43 SQ DAE	COMBI 43 Q DAE
Level	<b>EXPERT</b>	<b>EXPERT</b>	EXPERIENCE	EXPERIENCE	EXPERIENCE
Series	500 Series	500 Series	500 Series	500 Series	500 Series
Power source	Lithium-Ion battery	Lithium-Ion battery	Lithium-Ion battery	Lithium-Ion battery	Lithium-Ion battery
Recommended battery (Batteries & charger NOT included)	2 x 5Ah	2 x 4Ah	2 x 4Ah	2 x 4Ah	2 x 4Ah
Battery voltage	48 V	48 V	48 V	48 V	48 V
Maximum working area	750 m <sup>2</sup>	650 m <sup>2</sup>	600 m <sup>2</sup>	550 m <sup>2</sup>	550 m <sup>2</sup>
Cutting method	Collecting, mulching, side discharge, rear discharge	Collecting, mulching, side discharge, rear discharge	Collecting, mulching, side discharge, rear discharge	Collecting, mulching, side discharge, rear discharge	Collecting, mulching, side discharge, rear discharge
Cutting width	53 cm	48 cm	46 cm	41 cm	41 cm
Deck material	Galvanised steel	Galvanised steel	Galvanised steel	Galvanised steel	Galvanised steel
Cutting height adjustment	Centralised	Centralised	Centralised	Centralised	Centralised
Cutting height positions	5 positions	5 positions	6 positions	6 positions	6 positions
Cutting height range	25 - 80 mm	25 - 65 mm	22 - 80 mm	22 - 65 mm	22 - 65 mm
Driving	Self-propelled & electric power transmission with variable speed	Self-propelled & electric power transmission with variable speed	Self-propelled & electric power transmission with variable speed	Self-propelled & electric power transmission with variable speed	Hand-propelled
Eco mode	Yes	Yes	Yes	Yes	Yes
Collector capacity	70 L	70 L	60 L	60 L	60 L
Handlebar type	Digi handlebar with cam locks & soft grip	Digi handlebar with cam locks & soft grip	Digi handlebar with cam locks & soft grip	Digi handlebar with cam locks & soft grip	Digi handlebar with cam locks & soft grip
Wheels	200/280 grooved wheels on ball bearings with soft tread	180/240 grooved wheels on ball bearings with soft tread	200/280 grooved wheels on ball bearings with soft tread	200/200 grooved wheels on ball bearings with soft tread	200/200 grooved wheels on ball bearings with soft tread
Product weight	36 kg	31 kg	29 kg	30 kg	24 kg
Art.-Nr.	294557878/ST1	294507878/ST1	2L0483908/ST1	2L0433908/ST1	2L0431908/ST1
Warranty	2-Years	2-Years	2-Years	2-Years	2-Years

## COMBI 55 SQ

- 166 cc STIGA petrol engine
- Self-propelled with DSC (dynamic speed control) for gradual engagement of the drive
- 53 cm cutting width
- 70 litre grass collector with grassbag full indicator
- 4-in-1 cutting system: collection, mulching, side discharge and rear discharge modes



**STIGA**  
EXPERIENCE

PETROL	COMBI 50 SVEQ H	COMBI 55 SQ	COMBI 50 SQ
Level	<b>EXPERT</b>	EXPERIENCE	EXPERIENCE
Power source	Petrol	Petrol	Petrol
Power	2.75 kW	2.6 kW	2.2 kW
Engine Brand	Honda	STIGA	STIGA
Engine model	GCVxe145 OHV Autochoke	ST 170 OHV Autochoke	ST 140 OHV Autochoke
Displacement	145 cc	166 cc	139 cc
Engine rotation speed	2900 rpm	2900 rpm	2900 rpm
RPM control	Fixed rpm	Fixed rpm	Fixed rpm
Fuel tank capacity	0.95 L	1 L	0.75 L
Engine Oil tank capacity	0.4 L	0.55 L	0.5 L
Maximum working area	1600 m <sup>2</sup>	2000 m <sup>2</sup>	1600 m <sup>2</sup>
Cutting method	Collecting, Mulching, Side discharge, Rear discharge	Collecting, Mulching, Side discharge, Rear discharge	Collecting, Mulching, Side discharge, Rear discharge
Cutting width	48 cm	53 cm	48 cm
Deck material	Steel	Steel	Steel
Cutting height adjustment	Centralized	Centralized	Centralized
Cutting height positions	5 positions	5 positions	5 positions
Cutting height range	25 - 65 mm	25 - 80 mm	25 - 65 mm
Driving	Self-propelled	Self-propelled	Self-propelled
Speed variator	Yes	No	No
Collector capacity	70 L	70 L	70 L
Handlebar type	Ergonomic with cam locks + soft grip	Ergonomic with cam locks + soft grip	Ergonomic with cam locks + soft grip
Wheels	180/240 mm grooved wheels on ball bearings with soft tread	200/280 mm grooved wheels on ball bearings with soft tread	180/240 mm grooved wheels on ball bearings with soft tread
Washing link	Yes	Yes	Yes
Product weight	37 kg	36 kg	33 kg
Art.-Nr.	294503538/ST1	294556848/ST1	294502848/ST1
Warranty	5-Years*	5-Years*	5-Years*

\*Terms & conditions apply

## COMBI 44 E

- 1800 W electric motor
- Hand-propelled
- 42 cm cutting width
- 50 litre collector with window
- Can be used in rear discharge or mulching mode



**STIGA**  
EXPERIENCE

ELECTRIC	COMBI 44 E	COMBI 40 E	COMBI 36 E
Level	EXPERIENCE	EXPERIENCE	EXPERIENCE
Power source	Electric	Electric	Electric
Power cable	15m included	15m included	15m included
Power	1.8 kW	1.6 kW	1.4 kW
Maximum working area	800 m <sup>2</sup>	600 m <sup>2</sup>	400 m <sup>2</sup>
Cutting method	Collecting, Mulching, Rear discharge	Collecting, Mulching, Rear discharge	Collecting, Mulching, Rear discharge
Cutting width	42 cm	38 cm	34 cm
Deck material	Polypropylene	Polypropylene	Polypropylene
Cutting height adjustment	Centralized	Centralized	Centralized
Cutting height positions	6 positions	6 positions	6 positions
Cutting height range	25 - 75 mm	25 - 75 mm	25 - 75 mm
Driving	Push	Push	Push
Collector capacity	50 L	40 L	35 L
Handlebar type	Flat with cam locks and comfort switch + soft grip	Flat with cam locks and comfort switch + soft grip	Flat with cam locks and comfort switch + soft grip
Wheels	150/250 mm grooved wheels	150/250 mm grooved wheels	140/170 mm grooved wheels
Product weight	14 kg	13 kg	11 kg
Art.-Nr.	294420068/ST1	294380068/ST1	294340068/S15
Warranty	2-Years	2-Years	2-Years

## SLM 544 AE

- Reduced weight and dimensions for easy pushing
- Cordless, battery-powered engine with few noise and no emission
- Soft-grip handle for comfortable working
- Adjustable handle to adapt the working position to your needs
- Compatible with 500 Series System lineup



**EPower**  
DRIVEN BY STIGA

BATTERY	SLM 544 AE	SLM 540 AE	SLM 536 AE
Level	EXPERIENCE	EXPERIENCE	EXPERIENCE
Series	500 series	500 series	500 series
Power source	Lithium-ion battery	Lithium-ion battery	Lithium-ion battery
Battery Voltage	48 V	48 V	48 V
Recommended Battery (Batteries & charger NOT included)	1 x 5Ah	1 x 4Ah	1 x 2Ah
Run time	Up to 25 mins dependent on conditions	Up to 25 mins dependent on conditions	Up to 15 mins dependent on conditions
Maximum working area	400 m <sup>2</sup>	350 m <sup>2</sup>	200 m <sup>2</sup>
Cutting method	Collecting, Mulching, Rear discharge	Collecting, Mulching, Rear discharge	Collecting, Rear discharge
Mulching kit	included	included	-
Cutting width	42 cm	38 cm	34 cm
Deck material	Polypropylene / ABS	Polypropylene / ABS	Polypropylene / ABS
Cutting height adjustment	Centralized	Centralized	Centralized
Cutting height positions	6 positions	6 positions	6 positions
Cutting height range	25 - 75 mm	25 - 75 mm	25 - 75 mm
Eco-mode	Yes (automatic)	Yes (automatic)	Yes (automatic)
Driving	Push	Push	Push
Collector capacity	50 L	40 L	35 L
Handlebar type	Flat with cam locks and comfort switch + soft grip	Flat with cam locks and comfort switch + soft grip	Flat with cam locks and comfort switch + soft grip
Wheels	150/250 mm grooved wheels	150/250 mm grooved wheels	140/170 mm grooved wheels
Product weight	15 kg	14 kg	12 kg
Art.-Nr.	294424068/ST1	294384068/ST1	294344068/ST1
Warranty	2-Years	2-Years	2-Years

## COLLECTOR 140 AE



- Battery lawn mower for cable-free and stress-free mowing
- 40l hybrid grass catcher for small to medium-sized lawns
- Soft grip ergonomic handlebar that adjusts to your height
- 38cm cutting width, adjustable to six different heights
- Brushless motor means less maintenance and a longer lifespan
- 20V 2x4Ah battery and dual charger included



BATTERY	COLLECTOR 140 AE	COLLECTOR 136 AE	COLLECTOR 132 AE
Level	ESSENTIAL	ESSENTIAL	ESSENTIAL
Series	100 series	100 series	100 series
Power source	Lithium-ion battery	Lithium-ion battery	Lithium-ion battery
Battery capacity	2 x 4 Ah	2 x 2 Ah	4 Ah
Battery Voltage	20 V	20 V	20 V
Number of batteries	2 (Included)	2 (Included)	1 (Included)
Run time	Up to 25 mins dependent on conditions	Up to 15 mins dependent on conditions	Up to 20 mins dependent on conditions
Maximum working area	350 m <sup>2</sup>	250 m <sup>2</sup>	150 m <sup>2</sup>
Cutting method	Collecting	Collecting	Collecting
Cutting width	38 cm	34 cm	30 cm
Deck material	Polypropylene	Polypropylene	Polypropylene
Cutting height adjustment	Centralized	Centralized	on axles
Cutting height positions	6 positions	6 positions	3 positions
Cutting height range	25 - 75 mm	25 - 75 mm	30 - 70 mm
Eco-mode	No	No	No
Driving	Push	Push	Push
Speed variator	No	No	No
Collector capacity	40 L	35 L	30 L
Handlebar type	Ergonomic with double hand switch and cam locks + soft grip	Ergonomic with double hand switch and cam locks + soft grip	Flat with single hand switch
Wheels	140/170 mm grooved wheels	140/170 mm grooved wheels	140/140 mm grooved wheels
Product weight	12.26 kg	11.75 kg	8.79 kg
Art.-Nr.	291382068/UKS	291342068/UKS	291302068/UKS
Warranty	2-Years	2-Years	2-Years

## COLLECTOR 39 E

- 1400 W electric motor
- Hand-propelled
- 37 cm cutting width
- 40 litre collector with bag full indicator
- Collection and rear discharge functions



**STIGA**  
ESSENTIAL

ELECTRIC	COLLECTOR 39 E	COLLECTOR 35 E
Level	ESSENTIAL	ESSENTIAL
Power source	Electric	Electric
Power cable	15m (Included)	15m (Included)
Power	1.4 kW	1 kW
Maximum working area	500 m <sup>2</sup>	300 m <sup>2</sup>
Cutting method	Collecting	Collecting
Cutting width	37 cm	33 cm
Deck material	Polypropylene	Polypropylene
Cutting height adjustment	on axles	on axles
Cutting height positions	3 positions	3 positions
Cutting height range	25 - 65 mm	25 - 65 mm
Driving	Push	Push
Collector capacity	40 L	30 L
Handlebar type	Ergonomic with double hand switch	Ergonomic with double hand switch
Wheels	140/140 mm grooved wheels on ball bearings	140/140 mm grooved wheels on ball bearings
Product weight	15 kg	13 kg
Art.-Nr.	297370068/ST1	297330068/ST1
Warranty	2-Years	2-Years

# Multiclip

Save time, feed your lawn.

Robust, solid and efficient, STIGA Multiclip mowers feature specially-designed blades for top mulching results. These machines are built on steel chassis, resistant to knocks and rust. The STIGA Multiclip System cuts and recuts the grass into tiny pieces that simply wilt away, returning valuable nutrients back into the soil.

- **Multiclip technology**
- **Specially designed blades**
- **Strong and resistant chassis**
- **Time saver: reduces mowing time by 30%**
- **Cut and fertilize at the same time**
- **Reduce the need for watering**
- **Available power source: petrol and battery**





## MULTICLIP PRO 950 SX AE



- Powerful battery-powered selfpropelled mulching lawnmower
- Ultra-powerful 2.2kW brushless motor delivers efficient mowing and longer run time
- Ergonomic adjustable X-shape handlebar for easy manoeuvring
- Intuitive keypad with eco mode and six different speeds
- Extremely resistant aluminium wheel caps and sturdy front



BATTERY	MULTICLIP PRO 950 SX AE	MULTICLIP 750 S AE	MULTICLIP 747 AE
Level	<b>EXPERT</b>	EXPERIENCE	EXPERIENCE
Series	900 series	700 series	700 series
Power source	Lithium-ion battery	Lithium-ion battery	Lithium-ion battery
Battery Voltage	48 V	48 V	48 V
Recommended Battery (Batteries & charger NOT included)	2 x 7.5Ah	2 x 5Ah	1 x 4Ah
Run time	Up to 50 mins dependent on conditions	Up to 35 mins dependent on conditions	Up to 25 mins dependent on conditions
Maximum working area	1300 m <sup>2</sup>	850 m <sup>2</sup>	500 m <sup>2</sup>
Cutting method	Mulching	Mulching	Mulching
Cutting width	48 cm	48 cm	45 cm
Deck material	Galvanized steel	Galvanized steel	Galvanized steel
Cutting height adjustment	Centralized	Centralized	Centralized
Cutting height positions	5 positions	5 positions	5 positions
Cutting height range	31 - 75 mm	31 - 75 mm	31 - 80 mm
Eco-mode	Yes	Yes	No
Driving	Self-propelled	Self-propelled	Push
Speed variator	Yes electronic	Yes electronic	-
Handlebar type	Ergonomic 25 mm with keypad, double hand switch and cam locks + soft grip	Ergonomic 25 mm with keypad, double hand switch and cam locks + soft grip	Ergonomic 25 mm with keypad, double hand switch and cam locks + soft grip
Wheels	210/210 mm grooved aluminum wheels on ball bearings	210/210mm grooved wheels on ball bearings with soft tread	180/180 mm grooved wheels on ball bearings with soft tread
Product weight	34 kg	29 kg	23 kg
Art.-Nr.	291503098/ST1	291503178/ST1	298471178/ST1
Warranty	2-Years Domestic 1-Year Commercial	2-Years	2-Years

## MULTICLIP PRO 50 SX H

- 167 cc Honda petrol engine
- Self-propelled
- 48 cm cutting width
- STIGA Multiclip mulching function



**STIGA**  
**EXPERT**

PETROL	MULTICLIP PRO 50 SX H	MULTICLIP 50 SXE B	MULTICLIP 50 SX
Level	<b>EXPERT</b>	<b>EXPERT</b>	EXPERIENCE
Power source	Petrol	Petrol	Petrol
Power	3.3 kW	2.59 kW	2.6 kW
Engine brand	Honda	Briggs & Stratton	STIGA
Engine model	GCVx170 OHV Autochoke	B&S 675 iSi series InStart	ST 170 OHV Autochoke
Displacement	167 cc	163 cc	166 cc
Engine rotation speed	2900 rpm	2800 rpm	2900 rpm
RPM control	Fixed rpm	Fixed rpm	Fixed rpm
Fuel tank capacity	0.95 L	1 L	1 L
Engine Oil tank capacity	0.4 L	0.47 L	0.55 L
Maximum working area	1700 m <sup>2</sup>	1700 m <sup>2</sup>	1700 m <sup>2</sup>
Cutting method	Mulching	Mulching	Mulching
Cutting width	48 cm	48 cm	48 cm
Deck material	Galvanized steel	Galvanized steel	Galvanized steel
Cutting height adjustment	Centralized	Centralized	Centralized
Cutting height positions	5 positions	5 positions	5 positions
Cutting height range	31 - 75 mm	31 - 75 mm	31 - 75 mm
Driving	Self-propelled	Self-propelled	Self-propelled
Speed variator	-	-	-
Handlebar type	X-shape with rubbered lever and steel attachments	-shape with rubbered lever and steel attachments	X-shape with rubbered lever and steel attachments
Wheels	210/210 mm grooved aluminum wheels on ball bearings	210/210mm grooved wheels on ball bearings with soft tread	210/210mm grooved wheels on ball bearings with soft tread
Vibe Control System (VCS)	Yes	-	-
Product weight	37 kg	35 kg	34 kg
Art.-Nr.	291502138/ST1	291502528/ST1	291502048/ST1
Warranty	<b>5-Years* Domestic 1-Year Commercial</b>	<b>5-Years*</b>	<b>5-Years*</b>

\*Terms & conditions apply

## MULTICLIP 47 SQ

- Self-propelled - no need to push
- Equipped with patented Multiclip mulching blade
- Centrally-adjusted cutting height, up to 5 positions available
- Ergonomic, soft-grip handle
- Side-discharge available
- Robust and resistant steel cutting deck



**STIGA**  
EXPERIENCE

PETROL	MULTICLIP 47 SQ	MULTICLIP 47 S	MULTICLIP 47
Level	EXPERIENCE	ESSENTIAL	ESSENTIAL
Power source	Petrol	Petrol	Petrol
Power	2.2 kW	1.9 kW	1.9 kW
Engine brand	STIGA	STIGA	STIGA
Engine model	ST 140 OHV Autochoke	ST 120 OHV Autochoke	ST 120 OHV Autochoke
Displacement	139 cc	123 cc	123 cc
Engine rotation speed	2900 rpm	2900 rpm	2900 rpm
RPM control	Fixed rpm	Fixed rpm	Fixed rpm
Fuel tank capacity	0.75 L	0.75 L	0.75 L
Engine Oil tank capacity	0.5 L	0.5 L	0.5 L
Maximum working area	1500 m <sup>2</sup>	1500 m <sup>2</sup>	1500 m <sup>2</sup>
Cutting method	Mulching, Side discharge	Mulching	Mulching
Cutting width	45 cm	45 cm	45 cm
Deck material	Steel	Steel	Steel
Cutting height adjustment	Centralized	3 levers	4 levers
Cutting height positions	5 positions	5 positions	5 positions
Cutting height range	31 - 80 mm	31 - 80 mm	31 - 80 mm
Driving	Self-propelled	Self-propelled	Push
Speed variator	-	-	-
Handlebar type	Ergonomic + soft grip	Flat	Flat
Wheels	180/180 mm grooved wheels on ball bearings with soft tread	180/180 mm grooved wheels on ball bearings with soft tread	180/180 mm grooved wheels on ball bearings with soft tread
Vibe Control System (VCS)	-	-	-
Product weight	27 kg	25 kg	23 kg
Art.-Nr.	298472848/ST1	298472048/ST1	298471048/ST1
Warranty	5-Years*	5-Years*	5-Years*

\*Terms & conditions apply



# Accessories and attachments

## Blades



### STANDARD BLADE

Linear and sharp design guarantees a perfect cut and improves the grass collection in rear discharge mode.



### WINGED BLADES

They are designed with a special fin on both tips to facilitate cut grass down flow, through the exhaust manifold, up to the grass catcher.



### COMBI BLADES

This versatile design combines the waved shape of the mulching blades with the long fins of the winged blades, allowing this blade to be used either in rear discharge or mulching mode.



### MULCHING BLADES

Waved design that allows the blade to mince grass into small particles, that become nourishment for the lawn.



### DOUBLE-LAYERED BLADES

Double-edged design that represents the evolution of the mulching blades. This patent pending design doubles mowing efficiency cutting the grass in two different times for power saving and optimizes grass collection for the perfect cut.

Code	EAN	Length	Type	Fits for
1111-9290-01	7313329115670	340	Winged	Combi 36 E
1111-9157-02	7313329115755	367	Winged	Collector 39 E
1111-9292-01	7313329115694	380	Winged	Combi 40 E
1111-9142-02	7313329115731	410	Mulching	Combi: 43 AE, 43 S AE, 48, 48 AE, 48 E, 48 ES, 48 S, 48 S AE,
1111-9291-01	7313329115687	420	Winged	Combi 44 E
1111-9249-02	7313329115786	451	Mulching	Multiclip: 47 AE, 47 S AE, 747 AE
1111-9278-02	7313329115823	460	Mulching	Combi: 43 AE, 43 S AE, 48 S AE, 748 Q AE, 748 SQ AE
1111-9155-02	7313329115748	478	Mulching	Multiclip: 750 S AE, PRO 950 SX AE, 50 SXE B
1111-9192-02	7313329115762	480	Mulching	Combi: 50 S AE, 50 SVEQ B, 55 S AE, 55 SQ, 950 SQ AE, 50 SVQ, 50 SQ
1111-9256-02	7313329115793	480	Double-layered	Twinclip: 50 S, 50 SVE-R B, 55 SV H, 55 SVEQ B, 950 SQ AE
1111-9293-01	7313329115700	506	Mulching	Combi 753 SQ AE
1111-9279-02	7313329115830	520	Double-layered	Twinclip 55 S H BBC, Twinclip 55 S-R H BBC
1111-9277-02	7313329115816	525	Mulching	Combi: 50 SQ, 50 SQ B, 955 SQ AE
1111-9257-02	7313329115809	530	Double-layered	Twinclip: 50 S, 55 SV H, 55 SVEQ B, 50 SVEQ B

## Maintenance



1 - 2  
**Packaging**  
 Dimensions: 28 x 21 x 9 cm  
 Gross weight small: 0.565 kg approx.  
 Gross weight large: 0.680 kg approx.



3  
**Packaging**  
 Dimensions: 11.5 x 3.5 x 11 cm  
 Gross weight: 0.150 kg approx.

Pos	Code	EAN	Description	Measures
1	1111-9225-01	7313329115045	Small protective cover for walk-behind	145 x 50 x 110 cm
2	1111-9226-01	7313329115052	Large protective cover for walk-behind	180 x 50 x 110 cm
3	1111-9227-01	7313329115069	Scraper	

# Handhelds & Recycling



## For trimming, cutting, cleaning, soil and ground care

STIGA lawn trimmers, brushcutters and hedge trimmers are well balanced, ergonomic and performing machines, that combine great cutting results with maximum comfort. In case of rough grass, bushes or just lawn trimming, there is a STIGA machine to get the job done easily, efficiently and safely.

### Being a STIGA hand held



#### POWER AND PERFORMANCE

Reliable and powerful new engine technology guarantees perfect working activity, low emissions and -20% fuel consumption.



#### COMFORT AND SAFETY

Ergonomic soft-touch grip handles and a complex springs system ensure lower vibrations and a more comfortable experience.



#### RELIABILITY

Premium quality materials for strong and durable action and long-lasting machine life. Auto-choke system for enhanced performance and reliability.

# Hedge Trimmers

Precise cut and maximum comfort

## **PRECISE CUT**

The effective laser-cut double blade allows a fast and precise cut on any domestic hedge.

## **COMFORT**

An ergonomic handle - combined with an anti-vibration system – means users can work in the most natural and comfortable position.

## **ADJUSTABLE**

The rear handle can be turned through 180° and set in different positions for an easy shift from horizontal to vertical cutting.





## SHT 900 AE

- Battery hedge trimmer delivers 200 minutes of powerful cutting action
- 500W brushless motor ensures highperformance, continuous trimming
- Intuitive keypad for easy variable speed control and battery power management
- Ergonomic, soft-grip 180° rotating handle can be adjusted into 3 positions
- Robust cutter bar made from lightweight aluminium and high carbon steel
- Suggested battery: 48V 7.5Ah, plugged in the SBH 900 AE battery harness - both sold separately



BATTERY	SPH 900 AE	SHT 900 AE	SPH 700 AE	SHT 700 AE
Level	<b>EXPERT</b>	<b>EXPERT</b>	EXPERIENCE	EXPERIENCE
Series	900 series	900 series	700 series	700 series
Power source	Lithium-ion battery	Lithium-ion battery	Lithium-ion battery	Lithium-ion battery
Recommended battery capacity	2 x 7,5 Ah ( <b>Not Included</b> )	2 x 7,5 Ah ( <b>Not Included</b> )	4 Ah ( <b>Not Included</b> )	4 Ah ( <b>Not Included</b> )
Power	0.5 kW	0.5 kW	0.45 kW	0.45 kW
Motor type	Brushless	Brushless	With brushes	With brushes
Voltage	48 V	48 V	48 V	48 V
Working time (+/- 20%)	200 min	180 min	40 min	40 min
Cutting length	500 mm	600 mm	480 mm	560 mm
Blade length	520 mm	650 mm	500 mm	630 mm
Blade type	Dual action - Laser cut	Dual action - Laser cut	Dual action - Laser cut	Dual action - Laser cut
Blade teeth speed	2700 - 3000 - 3300 spm	3000 - 3300 - 3600 spm	3000 spm	3000 spm
Teeth distance	34 mm	40 mm	34 mm	34 mm
Cutting capacity	27 mm	33 mm	26 mm	26 mm
Handle type	Rear handle	Turnable 180° - 3 positions	Fix	Turnable 180° - 5 positions
Shaft extension	60 cm	-	65 cm	-
Telescopic handle extension length (max)	295 cm	-	300 cm	-
Product weight	7.1 kg	5 kg	6.1 kg	4 kg
Art.-Nr.	279710038/ST1	279300008/ST1	277710038/ST1	277300008/ST1
Warranty	2-Years	2-Years	2-Years	2-Years



**SPH 900 AE**



**SPH 700 AE**



**SHT 700 AE**



## SHT 500 AE

- 58cm dual-action blade makes trimming quicker
- 180° adjustable rear-handle - cut safely and comfortably at any angle
- Rapid 3500spm blade-speed
- 27mm tooth-spacing for a clean cut in thicker growth
- Battery compatible with all 48V System lineup



BATTERY	SHT 500 AE	SHT 100 AE KIT
Level	EXPERIENCE	ESSENTIAL
Series	500 series	100 series
Power source	Lithium-ion battery	Lithium-ion battery
Battery capacity	2 Ah	2 Ah
Recommended battery capacity	2 Ah ( <b>Not included</b> )	2 Ah (Battery & charger included)
Power	0.42 kW	0.15 kW
Motor type	With brushes	With brushes
Voltage	48 V	20 V
Working time (+/- 20%)	50 min	40 min
Cutting length	510 mm	500 mm
Blade length	580 mm	700 mm
Blade type	Dual action - Laser cut	Dual action
Blade teeth speed	3500 spm	2300 spm
Teeth distance	27 mm	25 mm
Cutting capacity	18 mm	18 mm
Handle type	Turnable 180° - 3 positions	Turnable 180° - 3 positions
Battery charger	Single standard	Single standard
Vibration level rear handle	2.32 m/s <sup>2</sup>	1.12 m/s <sup>2</sup>
Vibration level front handle	2.32 m/s <sup>2</sup>	0.80 m/s <sup>2</sup>
Product weight	3.5 kg	2.2 kg
Art.-Nr.	278300008/ST2	271302208/UKS
Warranty	2-Years	2-Years



**SHT 100 AE KIT**

## SHT 670

**STIGA**  
**EXPERT**

- Lightweight, balanced and high-performance 1.14 hp engine
- 70cm dual-action diamond-laser-cut blades
- Innovative anti-vibration system
- Easy disassembly for fast blade sharpening
- Ergonomic and adjustable front and rear handles
- Safe and simple to use, with easy-to-access air filter



Petrol	SHT 670	SHT 660
Level	<b>EXPERT</b>	EXPERIENCE
Power source	Petrol 2-stroke	Petrol 2-stroke
Power	0.65 kW	0.65 kW
Displacement	22.5 cc	22.5 cc
Idling speed (+/- 100)	3000 rpm	3000 rpm
Fuel tank capacity	0.26 L	0.26 L
Cutting length	560 mm	455 mm
Blade length	700 mm	595 mm
Blade type	Dual action - Laser cut	Dual action
Blade teeth speed	3000 spm	3000 spm
Teeth distance	35 mm	35 mm
Cutting capacity	27 mm	27 mm
Handle type	Turnable 180° - 3 positions	Turnable 180° - 3 positions
Product weight	5.2 kg	4.9 kg
Art.-Nr.	252422008/ST1	252421008/ST1
Warranty	2-Years	2-Years

## SHT 700

- 700 W electric motor
- 90° adjustable front handle with three positions
- 72 cm double-action blade
- 29 mm tooth spacing
- Blade speed 2400 spm



Electric	SHT 600	SHT 500
Level	EXPERIENCE	EXPERIENCE
Power source	Electric	Electric
Power	0.6 kW	0.5 kW
Power cable	15m (available separately)	15m (available separately)
Motor type	With brushes	With brushes
Cutting length	550 mm	450 mm
Blade length	600 mm	500 mm
Blade type	Dual action - Laser cut	Dual action
Blade teeth speed	1700 spm	1700 spm
Teeth distance	26 mm	22 mm
Cutting capacity	20 mm	16 mm
Handle type	Turnable 180° - 5 positions	Turnable 180° - 3 positions
Vibration level rear handle	2.99 m/s <sup>2</sup>	2.85 m/s <sup>2</sup>
Vibration level front handle	2.99 m/s <sup>2</sup>	2.85 m/s <sup>2</sup>
Product weight	3.2 kg	3.5 kg
Art.-Nr.	256060002/14	256050002/14
Warranty	2-Years	2-Years

# Lawn Trimmers & Brushcutters

Comprehensive range of powerful and reliable machines

## **CHOOSE YOUR POWER**

Available with different power sources, depending on your needs. Petrol engines are equipped with a technology that guarantees low emissions and -20% fuel consumption. For battery-powered models, you can choose your battery (see page 152).

## **COMFORT AND SAFETY**

Ergonomic soft-touch grip handles and an advanced springs system ensure lower vibrations and a more comfortable experience.

## **RELIABILITY**

Premium quality materials for strong and durable action and long-lasting machine life. Auto-choke system improves starting reliability.



## SBC 900 D AE

- Intelligent 1kW brushless motor – built to give years of powerful service
- LEDS display and cutting speed control in handle
- Lightweight aluminium gearcase for perfect balance and minimal noise
- Fast trimmer line reloading
- Ergonomic handlebar folds 90° for easy transport and storage
- Suggested battery: 48V 7.5Ah, plugged in the SBH 900 AE battery harness - both sold separately



BATTERY	SBC 900 D AE	SBC 700 D AE	SBC 700 AE
Level	<b>EXPERT</b>	EXPERIENCE	EXPERIENCE
Series	900 Series	700 Series	700 Series
Power source	Lithium-ion battery	Lithium-ion battery	Lithium-ion battery
Recommended battery	2 x 7.5 Ah ( <b>Not Included</b> )	4 Ah ( <b>Not Included</b> )	4 Ah ( <b>Not Included</b> )
Power	1 kW	0.5 kW	0.5 kW
Motor type	Brushless	Brushless	Brushless
Voltage	48 V	48 V	48 V
Working time (+/- 20%)	70 min	30 min	30 min
Nylon line diameter (millimeter)	2,4	2	2
Cutting width	43 cm	38 cm	38 cm
Cutting angle	Fixed	Fixed	Fixed
Nylon head type	Bump & Work dual line - Easy load	Bump & Work dual line - Easy load	Bump & Work dual line - Easy load
Blade type	3T ARC	3T ARC	3T ARC
Handle type	Bike	Bike	Loop Adjustable
Shaft type	Straight	Straight	Straight
Shaft tube diameter	25.4 mm	25 mm	25 mm
Harness	Double Comfort	Double Comfort	Single
Product weight	6.5 kg	4.8 kg	4.2 kg
Art.-Nr.	279210008/ST1	277210008/ST1	277200008/ST1
Warranty	2-Years	2-Years	2-Years



## SBC 700 D AE



## SBC 700 AE

## SBC 500 AE

- Powered by a next-generation 48 V battery
- Single loop handle
- Straight shaft
- 38 cm cutting width
- Tap&Go dual-line trimmer head and 4T blade included
- 4.0 Ah battery recommended (not included)



BATTERY	SBC 500 AE	SGT 500 AE	SGT 100 AE KIT
Level	EXPERIENCE	EXPERIENCE	ESSENTIAL
Series	500 Series	500 Series	100 Series
Power source	Lithium-ion battery	Lithium-ion battery	Lithium-ion battery
Recommended battery	4 Ah <b>(Not Included)</b>	2 Ah <b>(Not Included)</b>	2 Ah (Battery & charger included)
Power	0.5 kW	0.2 kW	0.15 kW
Motor type	Brushless	With brushes	With brushes
Voltage	48 V	48 V	20 V
Working time (+/- 20%)	30 min	20 min	20 min
Nylon line diameter (millimeter)	2	1,6	1,6
Cutting width	38 cm	30 cm	25 cm
Cutting angle	Fixed	Fixed + edge trimmer function	Adjustable
Nylon head type	Tap & Go dual line easy load	Automatic dual line	Automatic single line
Blade type	4 T	-	-
Handle type	Loop	Loop	Loop
Shaft type	Straight	Telescopic	Telescopic
Shaft tube diameter	25.4 mm	25.4 mm	26 mm
Harness	Single	No	No
Battery charger	-	-	Single standard
Vibration level rear handle (m/s <sup>2</sup> )	2.81	2.65	4.98
Vibration level front handle (m/s <sup>2</sup> )	3.63	2.65	2.87
Product weight	4.1 kg	3.1 kg	2 kg
Art.-Nr.	278200008/ST2	278100008/ST2	271102108/ST2
Warranty	2-Years	2-Years	2-Years



**SGT 500 AE**



**SGT 100 AE KIT**



## SBC 656 DX



- 52.8 cc 2-stroke petrol engine
- Bike-style handle
- Straight shaft
- 45 cm cutting width
- Tap&Go dual-line trimmer head and triarc blade included
- Double harness included



Petrol	SBC 656 DX	SBC 646 DX	SBC 636 D	SBC 636
Level	<b>EXPERT</b>	<b>EXPERT</b>	<b>EXPERT</b>	<b>EXPERT</b>
Power source	Petrol 2-stroke	Petrol 2-stroke	Petrol 2-stroke	Petrol 2-stroke
Power	1.7 kW	1.5 kW	1.2 kW	1.2 kW
Displacement	52.8 cc	44.8 cc	35.3 cc	35.3 cc
Idling speed (+/- 100)	3100 rpm	3000 rpm	3000 rpm	3000 rpm
Fuel tank capacity	0.8 L	0.8 L	0.6 L	0.6 L
Nylon line diameter (millimeter)	3	3	2,7	2,7
Cutting width	45 cm	45 cm	43 cm	43 cm
Nylon head type	Bump & Work dual line	Bump & Work dual line	Bump & Work dual line	Bump & Work dual line
Blade type	3T ARC	3T ARC	3T ARC	3T ARC
Handle type	Bike	Bike	Bike	Loop
Shaft type	Straight - Forest type	Straight	Straight	Straight
Shaft tube diameter	30 mm	30 mm	28 mm	28 mm
Harness	Double Comfort	Double Comfort	Double Comfort	Double Comfort
Product weight	8.2 kg	9.2 kg	7.45 kg	7.1 kg
Art.-Nr.	283524008/ST1	283424008/ST1	283321008/ST1	283320008/ST1
Warranty	<b>2-Years Domestic 1-Year Commercial</b>	<b>2-Years Domestic 1-Year Commercial</b>	<b>2-Years Domestic 1-Year Commercial</b>	<b>2-Years Domestic 1-Year Commercial</b>

## SBC 242 D



- 42.7 cc 2-stroke petrol engine
- Bike handlebar
- Straight shaft with reinforced support
- 45 cm cutting width
- Tap&Go Dual Line (Pro) strimmer head and 3T blade included
- Double harness included



Petrol	SBC 252 D	SBC 242 D	SBC 232 D	SBC 232
Level	EXPERIENCE	EXPERIENCE	EXPERIENCE	EXPERIENCE
Power source	Petrol 2-stroke	Petrol 2-stroke	Petrol 2-stroke	Petrol 2-stroke
Power	1.55 kW	1.25 kW	0.9 kW	0,9 kW
Displacement	51.7 cc	42.7 cc	32.6 cc	32.6 cc
Idling speed (+/- 100)	3100 rpm	3100 rpm	3100 rpm	3100 rpm
Fuel tank capacity	1 L	1 L	0.8 L	0.8 L
Nylon line diameter (millimeter)	2,8	2,8	2,4	2,4
Cutting width	45 cm	45 cm	43 cm	43 cm
Nylon head type	Bump & Work dual line	Bump & Work dual line	Bump & Work dual line	Bump & Work dual line
Blade type	3 T	3 T	3 T	3 T
Handle type	Bike	Bike	Bike	Loop
Shaft type	Straight - Forest type	Straight - Forest type	Straight - Forest type	Straigh
Shaft tube diameter	28 mm	28 mm	26 mm	26 mm
Harness	Double	Double	Double	Single
Product weight	8.3 kg	8.2 kg	7.8 kg	7.4 kg
Art.-Nr.	287421002/17	287321002/17	287221002/17	287220002/16
Warranty	2-Years	2-Years	2-Years	2-Years

## SBC 232 D



- 32.6 cc 2-stroke petrol engine
- Bike handlebar
- Straight shaft with reinforced support
- 43 cm cutting width
- Tap&Go Dual Line (Pro) strimmer head and 3T blade included
- Single harness included



Petrol	SBC 226 JD	SBC 226 J	SGT 226 J
Level	EXPERIENCE	EXPERIENCE	EXPERIENCE
Power source	Petrol 2-stroke	Petrol 2-stroke	Petrol 2-stroke
Power	0.7 kW	0.7 kW	0.7 kW
Displacement	25.4 cc	25.4 cc	25.4 cc
Idling speed (+/- 100)	3100 rpm	3100 rpm	3100 rpm
Fuel tank capacity	0.65 L	0.65 L	0.65 L
Nylon line diameter (millimeter)	2,4	2,4	2
Cutting width	43 cm	43 cm	38 cm
Nylon head type	Bump & Work dual line	Bump & Work dual line	Tap & Go dual line
Blade type	3 T	3 T	-
Handle type	Bike	Loop	Loop
Shaft type	Straight split	Straight split	Curved Split
Shaft tube diameter	26 mm	26 mm	26 mm
Harness	Single	Single	No
Product weight	6.8 kg	6.3 kg	5.7 kg
Art.-Nr.	287121102/ST1	287120102/ST1	287110102/ST1
Warranty	2-Years	2-Years	2-Years

ELECTRIC	SGT 600
Level	ESSENTIAL
Power source	Electric
Power	0.6 kW
Motor type	With brushes
Nylon line diameter (millimeter)	1,5
Cutting width	30 cm
Cutting angle	Adjustable
Nylon head type	Tap & Go dual line
Blade type	-
Handle type	Loop
Shaft type	Telescopic
Shaft tube diameter	28 mm
Harness	No
Product weight	2.8 kg
Art.-Nr.	252060002/14
Warranty	2-Years

# Accessories and attachments

## Trimmer heads

For Brushcutters and lawn trimmers, STIGA offers different cutting systems (nylon line and metal blades).



Code	EAN	Pos	Description	Specification	Fits for	Contains
1911-9292-01	7313324006775	-	Spool w. line	-	SGT 100 AE Kit	-
1911-9126-01	7313329190981	1	Spool w. line	-	SGT 600	-
1911-9251-01	7313324005310	2	Spool w. line	-	SGT 500 AE	-
1911-9197-01	7313329191728	3	Trimmer head	M8-female x 1.25, RH-thread	SGT 226 J	118801753/0
1911-9220-01	7313324003484	4	Trimmer head	M10-female x 1.25, LH-thread	SBC 80 AE, SBC 80D AE	118810304/0
1911-9223-01	7313324003491	5	Trimmer head	Pressed on motor shaft	SGT 48 AE	118803775/0
1911-9224-01	7313324003507	6	Trimmer head	M10-female x 1.25, LH-thread	SBC 48 AE (2017-)	118810717/0
1911-9225-01	7313323128416	7	Trimmer head	Pressed on motor shaft	SGT 24 AE	118810719/0
1911-9296t-01	7313323128416	8	Trimmer head	M10x1.25-LH	SBC 226 J, SBC 226 JD, SMT 226, SBC 232, SBC 232 D, SBC 242, SBC 242 D, SBC 252, SBC 252 D	118810719/0

### BUMP&WORK

Double line head.

Features:

- New design, handy and sturdy
- Higher flexibility spring for better line consumption control
- Extremely balanced at any rpm range
- Anti line-entangling design



Code	EAN	Pos	Description	Specification	Fits for
1911-9226-01	7313323128720	9	Trimmer head - Ø 109	M8 x 1.25 LH Female	SBC 226 J, 226 JD; SMT 226
1911-9227-01	7313323128737	10	Trimmer head - Ø 130	M8 x 1.25 LH Female	SBC 232, SBC 242, SBC 252 (mono - duplex, flex), 627, 635, 643, 645, 653 (mono - duplex - flex) , 636, 636 D, 646 DX, 656 DX
1911-9230-01	7313324003545	11	Trimmer head - Ø 109	M8 x 1.25 LH Male	
1911-9231-01	7313324003552	12	Trimmer head - Ø 130	M8 x 1.25 LH Male	

### BUMP&WORK - EASY LOAD

Easy and reliable, resistant double line head.

The line can be loaded in 30" without disassembling any part of the trimmer head.



Code	EAN	Pos	Description	Specification	Fits for
1911-9250-01	7313324005303	13	Trimmer head - Ø 102	M8 x 1.25 RH Female	SBC 500 AE



## Trimmer lines

### SP SQUARE

A 15 meter reel of square section line with a 2.4 mm diameter for STIGA lawn trimmers and brushcutters. This particular shape of line will guarantee a precise and quick cut.



Code	EAN	Section	Diameter (mm)	Length (m)	Type of pack
1911-9270-01	7313324005518	Square Line	2.4	15	Small Donut
1911-9271-01	7313324005525	Square Line	2.7	15	Small Donut
1911-9272-01	7313324005532	Square Line	3.0	15	Small Donut
1911-9286-01	7313324005686	Square Line	3.5	16	½ Dispenser
1911-9287-01	7313324005693	Square Line	4	12	½ Dispenser

Code	EAN	Section	Diameter (mm)	Length (m)	Type of pack
1911-9275-01	7313324005563	Square Line	2.4	69	Medium Donut
1911-9276-01	7313324005570	Square Line	2.7	55	Medium Donut
1911-9277-01	7313324005587	Square Line	3.0	44	Medium Donut
1911-9278-01	7313324005594	Square Line	3.5	32	Medium Donut
1911-9279-01	7313324005600	Square Line	4	25	Medium Donut

Code	EAN	Section	Diameter (mm)	Length (m)	Type of pack
1911-9280-01	7313324005617	Square Line	2.4	345	Spool
1911-9281-01	7313324005624	Square Line	2.7	275	Spool
1911-9282-01	7313324005631	Square Line	3.0	220	Spool
1911-9283-01	7313324005648	Square Line	3.5	160	Spool
1911-9284-01	7313324005655	Square Line	4	125	Spool

### ROUND TIGER SECTION

Professional quality, co-extruded trimmer lines for any type of use. Made with a unique blend of materials for superior cutting performance.

#### A more efficient cut:

- less breakage at the eyelet
- faster
- for grass and weeds
- flexible for better cutting around stony areas, fences and sidewalks.



Code	EAN	Section	Diameter (mm)	Length (m)	Type of pack
1911-9232-01	8008984811065	Round - Tiger	2.4	15	Small donut
1911-9233-01	8008984811072	Round - Tiger	2.7	15	Small donut
1911-9234-01	8008984811089	Round - Tiger	3.0	15	Small donut
1911-9254-01	7313324005341	Round - Tiger	3.5	9	Small donut
1911-9255-01	7313324005358	Round - Tiger	4.0	7	Small donut

Code	EAN	Section	Diameter (mm)	Length (m)	Type of pack
1911-9235-01	8008984811096	Round - Tiger	2.4	88	Medium donut
1911-9236-01	8008984811102	Round - Tiger	2.7	70	Medium donut
1911-9237-01	8008984811119	Round - Tiger	3.0	56	Medium donut
1911-9252-01	7313324005327	Round - Tiger	3.5	41	Medium donut
1911-9253-01	7313324005334	Round - Tiger	4.0	32	Medium donut

Code	EAN	Section	Diameter (mm)	Length (m)	Type of pack
1911-9238-01	8008984811126	Round - Tiger	2.4	437	Spool 3lb
1911-9239-01	8008984811133	Round - Tiger	3.0	279	Spool 3lb
1911-9256-01	7313324005365	Round - Tiger	3.5	205	Spool 3lb
1911-9257-01	7313324005372	Round - Tiger	4.0	156	Spool 3lb

## UNDULATED SECTION

SP66® is the only trimmer line that has been specifically developed for battery machines. SP66® has a patented raw material blend which is very hard wearing and has a higher melting point that eliminates welding in the head. The unique shaping process provides an aerodynamic profile with less air resistance, less vibrations and reduced noise emissions. These energy-saving features give a longer battery run time.

### Hard wearing:

- Superior resistance to abrasion and eyelet wear
- Very stable and durable

### Excellent aerodynamic Properties:

- Longer battery run time
- A faster cut than traditional lines
- Less effort required
- Reduced noise emission

### Usage:

- Battery machines
- All types of use



Code	EAN	Section	Diameter (mm)	Length (m)	Type of pack
1911-9240-01	8008984811140	Undulated - SP66	1.6	15	Small donut
1911-9241-01	8008984811256	Undulated - SP66	2.0	15	Small donut
1911-9242-01	8008984811263	Undulated - SP66	2.4	15	Small donut
1911-9243-01	8008984811270	Undulated - SP66	2.7	15	Small donut
1911-9244-01	8008984811287	Undulated - SP66	3	15	Small donut



Code	EAN	Section	Diameter (mm)	Length (m)	Type of pack
1911-9245-01	8008984811171	Undulated - SP66	1.6	196	Medium donut
1911-9246-01	8008984811188	Undulated - SP66	2.0	126	Medium donut
1911-9247-01	8008984811195	Undulated - SP66	2.4	87	Medium donut
1911-9248-01	8008984811201	Undulated - SP66	2.7	72	Medium donut
1911-9249-01	8008984811218	Undulated - SP66	3	56	Medium donut

## Blades, guards and harnesses



Code	EAN	Pos	Description	Fits for	Specification (mm)	Thickness
1911-9297-01	7313324006935	n.a.	3 arc blade	SBC 700 AE, 700 D AE, 900 AE		
1911-9262-01	7313324005426	1	3T blade	SBC: 226 J, 226 JD, 232, 232 D, 242, 242 D, 252 D	Ø = 255 - hole = 25.4	1.4 mm
1911-9263-01	7313324005433	2	3 arc blade	SBC: 646 DX, 656 DX - SBC: 242 D, 252 D, SBC 636, 636 D, 646 DX, 656 DX	Ø = 255 - hole = 25.4	3.0 mm
1911-9264-01	7313324005440	3	4T blade	SBC: 646 DX, 656 DX / SBC: 226 J, 226 JD, 232, 232 D, 242 D, 252 D	Ø = 255 - hole = 25.4	1.4 mm
1911-9196-01	7313329191711	3	4T blade	SBC: 48 AE, 80 AE, 80D AE	Ø = 230 - hole = 25.4	
1911-9265-01	7313324005457	n.a.	8T blade	SBC: 646 D, 646 DX, 656 DX	Ø = 255 - hole = 25.4	1.4 mm
1911-9266-01	7313324005464	4	24T saw blade	SBC: 646 DX, 656 DX	Ø = 228 - hole = 25.4	1.8 mm
1911-9267-01	7313324005471	n.a.	60T blade	SBC: 646 DX, 656 DX	Ø = 255 - hole = 25.4	1.4 mm
1911-6268-01	7313324005488	n.a.	80T blade	SBC: 646 DX, 656 DX	Ø = 255 - hole = 25.4	1.4 mm
1911-9269-01	7313324005495	5	Saw blade guard	SBC: 646 DX, 656 DX		
1911-9290-01	7313324005452	6	Kit saw blade (24T) + guard	SBC: 646 DX, 656 DX		
1911-9259-01	7313324005396	7	Double harness comfort	SBC: 646, 646 D, 646 DX, 656, 656 D, 656 DX		
1911-9260-01	7313324005402	8	Padded single harness	-		
1911-9261-01	7313324005419	9	Single harness	-		

# Chainsaws

Top cutting performance  
and complete safety

STIGA chainsaws are designed to help you cut wood, whether you are carrying out intensive maintenance work, cutting up logs or pruning trees at home, offering you the security of a well-balanced saw with a good power-to-weight ratio.

## **CHOOSE YOUR POWER**

Available with different power sources, depending on your needs. Petrol engines are equipped with a technology that guarantees low emissions and -25% fuel consumption. For battery-powered models, you can choose your battery (see page 152).

## **COMFORT AND SAFETY**

Ergonomic soft-grip handles and the spring-system ensure minimise vibration-transfer and a more comfortable working experience.

## **RELIABILITY**

Premium-quality materials guarantee superior performance and an extended product-life. Auto-choke system improves starting reliability.





## SPS 700 AE

- Battery pole saw for powerful, continuous cutting
- 65cm telescopic shaft extends to 270cm
- 25cm cutting bar with high-performance chain
- Ergonomic, soft grip handle and shaft, including harness hook
- Blade cover protects chain from damage
- Suggested 48V 4Ah battery is sold separately



BATTERY	SPS 700 AE
Level	EXPERIENCE
Series	700 series
Power source	Lithium-ion battery
Recommended battery	4 Ah <b>(Not Included)</b>
Power	0.45 kW
Motor type	With brushes
Voltage	48 V
Working time (+/-20%)	30 mins
Bar length	25 cm
Bar length (inches)	10 in
Chain type	3/8" .050" (91PX040E)
Chain speed	5 m/s
Chain brake	No
Chain oil pump	Automatic
Chain tensioning system	Side screw tensioning
Product weight	4.4 kg
Art.-Nr.	277710048/ST1
Warranty	2-Years



BATTERY	SPR 500 AE (12")*
Level	EXPERIENCE
Series	500 series
Power source	Lithium-ion battery
Recommended battery	4 Ah <b>(Not Included)</b>
Power	1 kW
Motor type	Brushless
Voltage	48 V
Working time (+/-20%)	12 mins
Bar length	30 cm
Bar length (inches)	12 in
Chain type	3/8" .050" (91PX045E)
Chain speed	20 m/s
Chain brake	Manual
Chain oil pump	Automatic
Chain tensioning system	Side screw tensioning
Battery charger	Single standard
Vibration level rear handle (m/s <sup>2</sup> )	3.72
Vibration level front handle (m/s <sup>2</sup> )	4.37
Product weight	3.45 kg
Product weight without bar and chain	3.1 kg
Art.-Nr.	278420008/ST2
Warranty	2-Years

\*WARNING: These top-handled chainsaws are for use by trained tree service operators only. Used without proper training can result in serious injury.

## SP 526 (20")

**STIGA**  
**EXPERT**

- 52 cc petrol engine with a net power output of 2.3 kW
- 50 cm (20") cutting bar
- Chain speed of 23.1 m/s
- Net weight of 5.3 kg without bar and chain
- Vibration control system (VCS)
- Tensioning wrench supplied



Petrol	SP 526 (20")	SPR 276 (10")	SP 466 (18")
Level	<b>EXPERT</b>	<b>EXPERT</b>	EXPERIENCE
Power source	Petrol 2-stroke	Petrol 2-stroke	Petrol 2-stroke
Power	2.3 kW	0.7 kW	2 kW
Displacement	52 cc	26.9 cc	46.5 cc
Engine rotation speed	12500 rpm	12400 rpm	12500 rpm
Idling speed (+/- 100)	3100 rpm	3100 rpm	3100 rpm
Fuel tank capacity	0.47 L	0.22 L	0.47 L
Bar length	50 cm	25 cm	45 cm
Bar length (inches)	20 in	10 in	18 in
Chain type	.325" .058" (21BPX078X)	3/8" .050" (91PX040X)	.325" .058" (21BPX072X)
Chain speed	23.1 m/s	22.86 m/s	23.1 m/s
Chain brake	Manual and inertial	Manual and inertial	Manual and inertial
Chain oil pump	Automatic adjustable	Automatic	Automatic adjustable
Chain tensioning system	Side screw tensioning	Side screw tensioning	Side screw tensioning
Vibration level rear handle (m/s <sup>2</sup> )	6.49	7.24	4.86
Vibration level front handle (m/s <sup>2</sup> )	6.04	6.93	4.85
Product weight	6.6 kg	3.75 kg	6.4 kg
Product weight without bar and chain	5.5 kg	3.1 kg	5.3 kg
Art.-Nr.	240522002/S17	240271002/ST1	240461802/S17
Warranty	2-Years	2-Years	2-Years

## SP 386 (16")

- 38.5 cc petrol engine with a power output of 1.6 kW
- 40 cm (16") cutting bar
- Chain speed of 22.8 m/s
- Net weight of 4.9 kg without bar and chain
- Vibration control system (VCS)
- Tensioning wrench supplied



Petrol	SP 386 (16")	SP 386 (14")
Level	EXPERIENCE	EXPERIENCE
Power source	Petrol 2-stroke	Petrol 2-stroke
Power	1.6 kW	1.6 kW
Displacement	38.5 cc	38.5 cc
Engine rotation speed	12000 rpm	12000 rpm
Idling speed (+/- 100)	3100 rpm	3100 rpm
Fuel tank capacity	0.51 L	0.51 L
Bar length	40 cm	35 cm
Bar length (inches)	16 in	14 in
Chain type	3/8" .050" (91PX057X)	3/8" .050" (91PX053X)
Chain speed	22.8 m/s	22.8 m/s
Chain brake	Manual and inertial	Manual and inertial
Chain oil pump	Automatic adjustable	Automatic adjustable
Chain tensioning system	Side screw tensioning	Side screw tensioning
Vibration level rear handle (m/s <sup>2</sup> )	4.37	4.37
Vibration level front handle (m/s <sup>2</sup> )	5.72	5.72
Product weight	5.5 kg	5.5 kg
Product weight without bar and chain	4.7 kg	4.7 kg
Art.-Nr.	240381602/S17	240381402/S17
Warranty	2-Years	2-Years

ELECTRIC	SE 1835 (14")
Level	ESSENTIAL
Power source	Electric
Power	1.8 kW
Power cable	15m (available separately)
Motor type	With brushes
Bar length	35 cm
Bar length (inches)	14 in
Chain type	3/8" .050" (91PX052E)
Chain speed	10 m/s
Chain brake	Manual and inertial
Chain oil pump	Automatic
Chain tensioning system	Side screw tensioning
Product weight	4.8 kg
Product weight without bar and chain	4.2 kg
Art.-Nr.	292614008/ST1
Warranty	2-Years

# Accessories and attachments

## Chain Loop



Code	EAN	Description	Length	Pitch	Width	Oregon equivalent
1519-9132-02	7313329152149	E1MC - BL	60E	1/4"	.050" (1.3 mm)	25AP
1519-9168-02	7313329151838	E1MC - BL	64E	1/4"	.050" (1.3 mm)	25AP
1519-9160-02	7313329151845	N1C	33E	3/8" mini	.050" (1.3 mm)	91PX
1519-9110-02	7313329151852	N1C	40E	3/8" mini	.050" (1.3 mm)	91PX
1519-9112-02	7313329151869	N1C	45E	3/8" mini	.050" (1.3 mm)	91PX
1519-9115-02	7313329151876	N1C	50E	3/8" mini	.050" (1.3 mm)	91PX
1519-9116-02	7313329151883	N1C	52E	3/8" mini	.050" (1.3 mm)	91PX
1519-9117-02	7313329151890	N1C	53E	3/8" mini	.050" (1.3 mm)	91PX
1519-9120-02	7313329151906	N1C	56E	3/8" mini	.050" (1.3 mm)	91PX
1519-9121-02	7313329151913	N1C	57E	3/8" mini	.050" (1.3 mm)	91PX
1519-9123-02	7313329151920	K1NK - BL	64E	.325"	.050" (1.3 mm)	95TXL
1519-9124-02	7313329151937	K1NK - BL	66E	.325"	.050" (1.3 mm)	95TXL
1519-9191-01	7313324005112	K2LX - BL	64E	.325"	.058" (1.5 mm)	21LPX
1519-9194-01	7313324005143	K2LX - BL	66E	.325"	.058" (1.5 mm)	21LPX
1519-9193-01	7313324005136	K2LX - BL	72E	.325"	.058" (1.5 mm)	21LPX
1519-9192-01	7313324005129	K2LX - BL	78E	.325"	.058" (1.5 mm)	21LPX
1519-9171-01	7313329151982	A2LM - BL	68E	3/8"	.058" (1.5 mm)	73 LPX
1519-9172-01	7313329151999	A2LM - BL	72E	3/8"	.058" (1.5 mm)	73 LPX
1519-9110-01	7313329151609	N1C	33E	3/8" mini	.050" (1.3 mm)	91PX

## Chain Reel



Code	EAN	Description	Links n.	Pitch	Gauge	Oregon Equivalent
1519-9173-02	7313329152002	E1 MC - BL - 100R	2392	1/4"	.050" 1.3 mm	25AP - 100R
1519-9174-02	7313329152019	N1C - 100R	1640	3/8" mini	.050" 1.3 mm	91PX - 100R
1519-9175-01	7313329152026	K2C - BL - 100R	1848	.325"	.058" 1.5 mm	21BPX - 100R
1519-9177-01	7313329152040	A2EP - BL - 100R	1640	3/8"	.058" 1.5 mm	73DPX - 100R
1519-9178-01	7313329152057	A2LM - BL - 100R	1640	3/8"	.058" 1.5 mm	73LPX - 100R
1519-9197-02	7313324006232	K1C-BL-100R	1848	.325"	.050" 1.3 mm	95VP - 100R

## Joint Kit



Code	EAN	Description	Pieces
1519-9179-01	7313329152064	Joint Kit 25	25
1519-9180-01	7313329152071	Joint Kit 25 with Rivets	25
1519-9181-01	7313329152088	Joint Kit 91	25
1519-9182-01	7313329152095	Joint Kit 91 with Rivets	25
1519-9183-01	7313329152101	Joint Kit 21	25
1519-9184-01	7313329152118	Joint Kit 21 with Rivets	25
1519-9185-01	7313329152125	Joint Kit 73	25
1519-9186-01	7313329152132	Joint Kit 73 with Rivets	25

## Files and Filing Kit



1 - 2 - 3



4 - 5 - 6

Pos	Code	EAN	Description	File diameter	Section	Pack of
1	1519-9102-01	7313329151548	Files	5/32" (4.0 mm)	●	3
2	1519-9103-01	7313329151555	Files	3/16" (4.8 mm)	●	3
3	1519-9104-01	7313329151562	Files	7/32" (5.6 mm)	●	3
4	1519-9105-01	7313329151579	Filing kit	5/32" (4.0 mm)	●	-
5	1519-9106-01	7313329151586	Filing kit	3/16" (4.8 mm)	●	-
6	1519-9107-01	7313329151593	Filing kit	7/32" (5.6 mm)	●	-



# Garden Multi-Mate

The handy way to trim, cut, shape, prune and aerate

## CLEAN AND GREEN

Battery-powered for clean, green gardening. High energy-efficiency, low vibrations, reduced noise and minimum maintenance. Perfect for trimming shrubs and small bushes and keeping edges neat and trim.

## EASY

Easy plug-in battery charger for immediate re-charge. Accessories are quick and simple to attach via a tool-free 'click-in' system. Compact and easy to store.

## VERSATILE

A grass and shrub blade are included; in addition there are different sized blades, a pruning disc, soil grubber and telescopic handle available to purchase separately.

## PRODUCT HERO

### SGM 102 AE

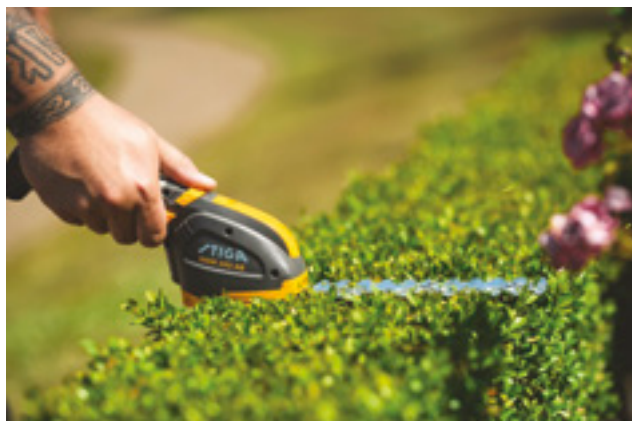

**SHRUB BLADE**

Precise hedge trimming, bushes shaping and box edge sculpturing.

**GRASS BLADE**

Accurate lawn trimming, lawn edging for a perfect finish.

**PRUNING DISC**

Sharp pruning of hedge, bush and tree branches.

**SOIL GRUBBER**

Assisted soil care on vases and flowerbeds.

BATTERY	SGM 102 AE	SGM 72 AE
Level	ESSENTIAL	ESSENTIAL
Power source	Lithium-ion battery	Lithium-ion battery
Battery capacity	2.5 Ah	2.5 Ah
Motor type	With brushes	With brushes
Voltage	10.8 V	7.2 V
Working time (+/- 20%)	110 min	75 min
Hedger working time (+/-20%)	160 min	110 min
Shrub shear cutting length	180 mm	180 mm
Handle type	Turnable 180° - 3 positions	Fix
Art.-Nr.	253010341/ST1	253007331/ST1
Warranty	2-Years	2-Years





# Accessories and attachments



Pos	Code	EAN	Description	Fits for	Note	Packaging
1	232522011/ST1	8008984814912	Grass blade 8 cm	SGM 72 AE, SGM 102 AE	Accurate lawn trimming, awn edging	Blister
1	232522021/ST1	8008984814929	Grass blade 11 cm	SGM 72 AE, SGM 102 AE	Accurate lawn trimming, awn edging	Blister
1	232522031/ST1	8008984814936	Grass blade 13 cm	SGM 72 AE, SGM 102 AE	Accurate lawn trimming, awn edging	Blister
2	232522041/ST1	8008984814943	Shrub blade 18 cm	SGM 72 AE, SGM 102 AE	Precise hedge trimming, bushes shaping, box edge sculpturing	Blister
2	232522051/ST1	8008984815162	Shrub blade 20 cm	SGM 72 AE, SGM 102 AE	Precise hedge trimming, bushes shaping, box edge sculpturing	Blister
3	232523011/ST1	8008984815155	Soil grubber	SGM 102 AE	Assisted soil care on vases and flowerbeds	Blister
4	232523021/ST1	8008984815179	Pruning cutter	SGM 72 AE, SGM 102 AE	Sharp pruning of hedge, bush and tree branches	Blister
5	232521021/ST1	8008984807754	Telescopic handle	SGM 72 AE, SGM 102 AE	Tilting shaft, 3 cutting height positions	Plastic bag + carton hanger
6	232524011/ST1	8008984815186	Textile bag	SGM 72 AE, SGM 102 AE	For easy transport and storage	Plastic bag
7	1800-9011-01	8008984813151	Battery charger	SGM 72 AE	0.5 A (7.2 V) BS plug	Blister
7	1800-9012-01	8008984813168	Battery charger	SGM 102 AE	0.5 A (10.8 V) BS plug	Blister

# Multi-tool

One machine, many uses

## **MADE TO REACH HIGHER**

For gardens with difficult to reach bushes, trees and shrubs, a multi-tool is the answer. STIGA multi-tools are versatile products that plug into a single body and motor.

## **CHOOSE YOUR POWER**

With a range of different power sources depending on the consumer requirements.

## **VERSATILITY**

Extremely adaptable and with a wide range of accessories they are ideal for managing different tasks in the garden.



## SMT 500 AE

- Lightweight battery multi tool for hedge cutting and pruning
- 65cm telescopic extension reaches 2.95m (hedge trimmer) and 2.70m (pruner saw)
- 46cm dual action laser-cut hedge trimmer blade and 25cm pruner cutting bar
- 112° rotating handle, soft touch rubber grip handle and shaft
- Bumper on pruner attachment delivers maximum cutting precision



BATTERY	SMT 500 AE	SMT 100 AE KIT
Level	EXPERIENCE	ESSENTIAL
Series	500 series	100 series
Power source	Lithium-ion battery	Lithium-ion battery
Recommended battery	4 Ah ( <b>Not Included</b> )	4 Ah (Battery & charger included)
Motor type	With brushes	With brushes
Power (hedger function)	350 W	150 W
Power (pruner function)	350 W	280 W
Voltage	48 V	20 V
Hedger working time (+/-20%)	40 min	70 min
Pruner working time (+/-20%)	15 min	20 min
Cutting length	44 cm	415 mm
Blade length	46 cm	455 mm
Teeth distance	28 mm	18 mm
Bar length (inches)	10 in	8 in
Chain type	3/8" .050" (91PX040E)	3/8" .050" (91PJ033X)
Chain speed	5 m/s	5 m/s
Chain oil pump	Automatic	-
Handle type	Loop	Rear handle
Shaft extension	65 cm	-
Product weight (hedger version)	4.7 kg	3.1 kg
Product weight (pruner version)	4.3 kg	3.2 kg
Art.-Nr.	278720008/ST2	271724208/UKS
Warranty	2-Years	2-Years



## SMT 226 – 5 IN 1



- 38.5 cc petrol engine with a power output of 1.6 kW
- 40 cm (16") cutting bar
- Chain speed of 22.8 m/s
- Net weight of 4.9 kg without bar and chain
- Vibration control system (VCS)
- Tensioning wrench supplied



Petrol	BRUSHCUTTER	HEDGETRIMMER	PRUNER
Level	EXPERIENCE	-	-
Power source	Petrol 2-stroke	-	-
Power	0.7 kW	-	-
Displacement	25.4 cc	-	-
Engine rotation speed	11000 rpm	-	-
Fuel tank capacity	0.65 L	-	-
Cutting width	43 cm	-	-
Cutting length	40 cm	-	-
Nylon head type	Tap & Go dual line	-	-
Teeth distance	-	25 mm	-
Blade type (brushcutter)	3 T	-	-
Bar length (inches)	-	-	10 in
Chain speed	-	-	5.20 m/s
Chain oil pump	-	-	Automatic
Handle type	Loop	-	-
Shaft extension	-	70 cm	70 cm
Included tools kit	Spark plug key, screwdriver	-	-
Hedger guaranteed sound power level (LwA) dB(A)	-	107	-
Pruner guaranteed sound power level (LwA) dB(A)	-	-	111
Hedger vibrations level (front/rear handle) (m/s <sup>2</sup> )	-	7.13	-
Pruner vibrations level (front/rear handle) (m/s <sup>2</sup> )	-	-	7.13
Brushcutter guaranteed sound power level (LwA) dB(A)	109	-	-
Product weight	6.75 kg	6.7 kg	6.4 kg
Art.-Nr.	287130152/ST1		
Warranty	2-Years		

# Shredder

Get rid of garden waste with an eco-friendly tool

## KIND TO NATURE

Easy-to-use and environmentally-friendly machines to dispose of garden waste, both green and woody. The STIGA shredder is electrically powered.

## EASY TO USE

The bio silent shredder will effortlessly reduce garden-debris to a useful and valuable organic fertiliser for vegetable plots and flowerbeds.

## RECYCLE WASTE

These machines make gardening simpler, allowing the user to choose how to re-use garden waste.



<b>ELECTRIC</b>	<b>BIO SILENT 2500</b>
Level	ESSENTIAL
Motor type	Brushless
Maximum motor speed	2850 RPM
Motor power	2500 Watt
Maximum branch diameter	40 mm
Cutting method	Rotating roller with 8 teeth
Reverse function	Yes
Collector capacity	60 L
Included tools kit	Feeder
Guaranteed sound power level (LwA)	97 dB(A)
Product weight	27.4 kg
Art.-Nr.	290001252/14
Warranty	2-Years

# Scarifiers

Breathe new life into your lawn

## AERATE THE SOIL

The perfect machines for ground aeration, STIGA scarifiers will keep the lawn healthy and beautiful, right down to the roots.

## RELIABLE MACHINES

Suitable for soil and ground-care jobs, including bed-preparation and aeration.

## DIFFERENT POWER SOURCES AVAILABLE

STIGA scarifiers are available with electric- or petrol-powered engine, to suit all needs.



ELECTRIC	SV 415 E	SV 213 E
Level	ESSENTIAL	ESSENTIAL
Motor type	With brushes	With brushes
Motor power	1500 W	1300 W
Working method	20 blades or 44 springs	16 blades or 36 springs
Working width	38 cm	32 cm
Working depth	1.30 cm	0.60 cm
Double function	Yes	Yes
Number of springs	44	36
Collector capacity	50 L	40 L
Wheels size Ø	160 mm	200 mm
Guaranteed sound power level (LwA)	94 dB(A)	94 dB(A)
Product weight	14.50 kg	9.8 kg
Art.-Nr.	290002152/14	290002132/14
Warranty	2-Years	2-Years

PETROL	SVP 40 G
Level	EXPERIENCE
Power source	Petrol 4-stroke
Power	4 kW
Displacement	182 cc
Fuel tank capacity	3
Working method	32 floating knives
Working width	40 cm
Working depth	1.5 cm
Double function	No
Collector capacity	50 L
Wheels size	180 mm
Product weight	44 kg
Art.-Nr.	290002152/14
Warranty	2-Years

# Tillers and Scythe

Versatility and ease-of-use  
to face the most challenging tasks

## PREPARE THE GROUND

The perfect machines for ground preparation, to break-up and mix up clogs of earth, before seeds are sown.

## VERSATILE

The numerous accessories available mean these tools are extremely versatile.

## RELIABLE

Suitable for a variety of heavy-duty soil and ground-care jobs, including bed-preparation, aeration, ploughing and fertiliser-application.



### Rotary Garden Tillers

PETROL	SRC 775 RG
Level	EXPERIENCE
Engine brand/model	TM 60 OHV
Displacement	182 cc
Engine net power	3.10 kW @ 3300 RPM
Fuel tank capacity	3.0 L
Working width	75 cm
Working depth	26 cm
Rotors number	6
Rotors diameter	320 mm
Tree saver discs	Yes
Adjustable handlebar	Vertical and horizontal
Transmission type	Chain and gears in oil bath + belt
Transport wheels	1 front wheel
Guaranteed sound power level (LwA)	96 dB(A)
Product weight	53 kg
Art.-Nr.	212751142/14
Warranty	2-Years



## Rotary Garden Tillers



PETROL	SRC 550 RB	SRC 36 V
Level	EXPERIENCE	ESSENTIAL
Engine brand/model	Briggs & Stratton / 450 series	Stiga / ST 120 OHV Autochoke
Displacement	125 cc	123 cc
Engine net power	1.66 kW @ 3100 RPM	1.90 kW @ 3200 RPM
Fuel tank capacity	0.8 L	0.75 L
Working width	50 cm	36 cm
Working depth	20 cm	20 cm
Rotors number	4	4
Rotors diameter	260 mm	260 mm
Tree saver discs	Yes	-
Adjustable handlebar	Vertical and horizontal	Yes
Transmission type	Chain and gears in oil bath + belt	Chain and gears in oil bath + belt
Transport wheels	2 rear wheels	1 front wheel
Guaranteed sound power level (LwA)	93 dB(A)	93 dB(A)
Product weight	42 kg	27 kg
Art.-Nr.	212501022/14	211360042/ST1
Warranty	2-Years	2-Years

## Multi-functional machines and Cultivators



Scythe

PETROL	SILEX 103 B	SILEX 95 H	SILEX 95 B	SILEX 87 B
Level	EXPERIENCE	EXPERIENCE	EXPERIENCE	EXPERIENCE
Engine brand/model	Briggs & Stratton / CR 950	Honda / GCV 160	Briggs & Stratton / 675 EXi series Ready Start	Briggs & Stratton / 575 EX series
Displacement	208 cc	160 cc	163 cc	140 cc
Engine net power	4.80 kW @ 3200 RPM	2.80 Kw @ 3100 RPM	2.74 kW @ 3200 RPM	2.27 kW @ 2900 RPM
Fuel tank capacity	3.8 L	0.9 L	1 L	1 L
Working width	60 cm	-	-	87 cm
Working depth	22 cm	-	-	-
Cutting height range	-	-	-	20 - 50 mm
Teeth distance	-	-	-	52 mm
Rotors number	6	-	-	-
Rotors diameter	320 mm	-	-	-
Adjustable handlebar	Yes	Yes	Yes	Height
Transmission type	Chain and gears in oil bath + belt	Chain and gears in oil bath + belt	Chain and gears in oil bath + belt	-
Transport wheels	15 x 5.00-6 (pneumatic)	13 x 5.00-6 (pneumatic)	13 x 5.00-6 (pneumatic)	13 x 5.00 - 6 (pneumatic)
Product weight	70 kg	52 kg	52 kg	51 kg
Art.-Nr.	210310022/10	219510032/10	219510022/10	210870022/09
Warranty	2-Years	2-Years	2-Years	2-Years



# Accessories and attachments

## TILLER

SRC 550 RB

SRC 775 RG

Product name	Art. N.	Pos		
Ridging plough	219000050/08	1	•	
Kit adjustable spur	219000170/14	2		•
Tyres	219000070/08	3		•



1  
Ridging plough



2  
Kit adjustable spur



3  
Tyres

## SILEX 95 AND 103

Silex 95

Silex 103

Product name	Art. N.	Pos		
Front brush 80 cm	290950040/10	1	•	
Grassland mower 53 cm	290950010/10	2	•	
Snow blade 85 cm	290950050/10	3	•	
Ridging plough	290950060/10	4	•	
Front brush 105 cm	290950070/10	5	•	
Double blade cutting bar 87 cm	290950030/10	6	•	
Rear mounted rotavator 50 cm	290950020/10	7	•	
Ridging plough	290030020/10	8		•
Rear mounted rotavator 32 cm	290030010/10	9		•



1  
Front brush



2  
Grassland mower



3  
Snow blade



4  
Ridging plough



5  
Front brush



6  
Double blade cutting bar



7  
Rear mounted rotavator



8  
Ridging plough



9  
Rear mounted rotavator

# Cleaning



# Powerful and easy-to-use cleaning tools for outdoor surfaces

Cleaning outdoor areas has never been easier.

The STIGA Cleaning range offers different solutions, to take care of your outdoor and get easily rid of dead leaves, grass cuttings, mud, dirt, dust or snow.



**BLOWERS**

A well-ordered, healthy garden also requires the removal of dry leaves – an essential task for reducing the formation of mosses and fungi and keeping your lawn in a healthy balance. STIGA leaf blowers/ vacuums make this task easier, giving you the power you need to get the job done quickly.



**HIGH PRESSURE CLEANERS**

When sweeping and collecting just doesn't get the job done, eliminate mould, grime, dust and mud with one of our pressure washers. From cleaning garden tools, cars and footpaths to outdoor toys, decking and even boats and caravans.



**SWEEPERS**

STIGA outdoor sweepers are the perfect product for cleaning snow, build-ups of leaves, dirt and lawn clippings from driveways and footpaths. Whether you need a manual or motorised product, you will find the right one to clean your surface.



# High Pressure Cleaners

## Tackle the toughest of cleaning jobs

### EASY TO USE

Just plug into any home electric power point and a water source and you are ready to start cleaning. Operating pressures range from 135bar through to 150bar, with all models benefitting from a handy integrated hose-reel.

### CLEAN ANY SURFACE

STIGA high-pressure washers will blast off dirt, dust and grime from a range of surfaces. Detergent tanks make it possible to introduce soap into the mix when tackling deeply ingrained oil and grease.

### VERSATILE MACHINES

Practical and convenient, STIGA pressure washers are ideal for cleaning patios, decking, walls, tarmac, engines and much more. With a wide range of compatible parts and accessories they become extremely versatile.

## Surfaces

	HPS 650 RG	HPS 550	HPS 345 R	HPS 235 R
	•	•	•	•
	•	•	•	•
	•	•	•	•
	•	•	•	•
	•	•	•	•
	•	•	•	•
	•	•	•	•
	•	•	•	
	•	•	•	
	•	•		
	•	•		
	•			



## HPS 650 RG



## HPS 345 R



ELECTRIC	HPS 650 RG	HPS 550 R	HPS 345 R	HPS 235 R
Level	EXPERIENCE	EXPERIENCE	EXPERIENCE	EXPERIENCE
Motor power	2800 Watt	2500 Watt	2100 Watt	1800 Watt
Motor class	Induction (220-240 V)	Induction (220-240 V)	Induction (220-240 V)	Universal (220-240 V)
Max pressure	150 bar	150 bar	145 bar	135 bar
Max rated flow	550 l/h	520 l/h	450 l/h	440 l/h
Max water inlet temperature	50 °C	50 °C	50 °C	50 °C
Head pump material	Brass	Brass	Aluminum	Aluminum
Pistons material	Stainless steel	Stainless steel	Stainless steel	Stainless steel
Handlebar type	Telescopic with over injection	Telescopic with over injection	Telescopic with over injection	Telescopic with over injection
Electric cable length	5 m	5 m	5 m	5 m
Gun type	Stiga T5 with Extra Comfort Handle	Stiga T5 with Extra Comfort Handle	Stiga T3 - Plastic	Stiga T3 - Plastic
High pressure hose length	12 m	10 m	9 m	6 m
High pressure hose material	Steel reinforced	Steel reinforced	Steel reinforced	Supersoft
Hose reel	Yes	Yes	Yes	Yes
Standard lance	Metal lances	Metal lances	Extension lance T3	Extension lance T3
Nozzle	Adjustable and rotary nozzle	Adjustable and rotary nozzle	Adjustable and rotary nozzle	Adjustable and rotary nozzle
Detergent device	Built-in tank (1.0 L)	Built-in tank (1.0 L)	Foam sprayer (0.4 L)	Foam sprayer (0.4 L)
Pressure adjustment	Yes	-	-	-
Accessory holder	Onboard storage	Onboard storage	Foldable front cover	Foldable front cover
Product weight	27 kg	24.4 kg	17.4 kg	12.3 kg
Art.-Nr.	2C1502804/UKS	2C1502504/UKS	2C1452113/UKS	2C1351811/UKS
Warranty	2-Years	2-Years	2-Years	2-Years

# Accessories and attachments

STIGA suggests to always chose original spare parts and accessories to improve the features of STIGA cleaning machines. Guns, jet nozzles, lance extensions and other tools are available in branded boxes.



Code	EAN	Pos	Description	Note	HPS 235 R	HPS 345 R	HPS 550 R	HPS 650 RG
1500-9001-01	7313323128430	1	Trigger gun T3		S	S	-	-
1500-9002-01	7313323128447	2	Trigger gun T5		-	-	S	S
1500-9003-01	7313323128454	3	Rotary jet nozzle T1-T3		S	S	-	-
1500-9004-01	7313323128461	4	Adjustable jet nozzle T1		-	-	-	-
1500-9030-01	7313323128744	4	Adjustable jet nozzle T2		S	-	-	-
1500-9005-01	7313323128478	5	Adjustable jet nozzle T3		-	S	-	-
1500-9007-01	7313323128492	6	Lance extension T3		S	S	-	-
1500-9034-01	7313324006614	-	Extention lance	For HPS 110 - 235 - 345	S	S	-	-
1500-9035-01	7313324006621	-	Extention lance	For 550 - 650 series	-	-	S	S
1500-9008-01	7313323128508	7	Lance T5	With rotary nozzle	-	-	S	S
1500-9009-01	7313323128515	8	Lance T5	With jet nozzle	-	-	S	S
1500-9010-01	7313323128522	9	HP hose	8 m	S	S	-	-
1500-9011-01	7313323128539	10	HP steel reinforced hose	12 m	-	-	S	S
1500-9032-01	7313324005198	9	HP steel reinforced hose	9 m	-	S	-	-
1500-9033-01	7313324005204	9	Supersoft hose	6 m	S	-	-	-
1500-9031-01	7313324005105	11	Foam spray bottle kit	Bottle capacity 0.75 L	S	S	-	-
1500-9013-01	7313323128553	12	Mini Patio	Brush for cleaning large areas.	0	0	-	-
1500-9014-01	7313323128560	13	Patio Deluxe	Brush for cleaning large areas with detergent tank and setting function.	-	-	0	0
1500-9015-01	7313323128577	14	Fixed brush	Universal soft bristle brush suitable for all surfaces.	0	0	0	0
1500-9016-01	7313323128584	15	Rotary Brush	For cleaning all smooth surfaces (car/motorbike bodies and plastic or glass surfaces). The rotary brush's bristles clean the surface gently.	0	0	0	0
1500-9017-01	7313323128591	16	Water suction kit	Accessory for sucking up water. Ideal for high-speed emptying of tanks or cisterns. Connections included in kit.	0	0	0	0
1500-9018-01	7313323128607	17	Pipe drain hose kit 10 m	Ideal for cleaning grids, gutters or drain pipes. Connections included.	0	0	0	0
1500-9019-01	7313323128614	18	Pipe drain hose kit 16 m	Ideal for cleaning grids, gutters or drain pipes. Connections included.	0	0	0	0
1500-9020-01	7313323128621	19	Underbody lance kit	It rotates 180° for cleaning difficult to reach areas. Connection between gun and accessory or extension lance and accessory.	0	0	-	-
1500-9021-01	7313323128638	20	Hose extension	HP hose extension 8 m	0	-	-	-
1500-9022-01	7313323128645	21	Hose extension	Reinforced HP hose extension 8 m	-	0	0	0
1500-9023-01	7313323128652	22	Click fast kit	Click fast connection device for water intake or other accessories.	0	0	0	0
1500-9024-01	7313323128669	23	Inspectable water filter	Inspectable water intake connection 3/4" G (F) with removable filter.	S	S	S	S
1500-9025-01	7313323128676	24	Adaptors kit	Set of adapters for accessories of various makes.	0	0	0	0
1500-9026-01	7313323128683	25	Adaptors kit	Set of adapters for machines of various makes.	0	0	0	0
1500-9027-01	7313323128690	26	Detergent	For bicycles and motorbikes	0	0	0	0
1500-9028-01	7313323128706	27	Detergent	For boats and cars	0	0	0	0
1500-9029-01	7313323128713	28	Detergent	Universal	0	0	0	0





# Blowers

## An Autumn essential

### STRONG AND PRECISE

Thanks to their vacuum-capability (selected models) and focused airflow that avoids air dispersion, these machines are the ideal workmate in the battle to keep the garden and other outdoor spaces tidy, making them the essential Autumn garden tool!

### EASY TO USE

STIGA leaves-blowers are lightweight machines that will make it quick and easy to get the job done. Their perfect balance ensures maximum comfort.

### KEEP LAWN HEALTHY

The removal of dead, dried-out leaves, will keep the lawn healthy by avoiding the formation of growth-inhibiting moss and fungi.



PETROL	SBP 375	SBL 327 V	SBL 327
Level	<b>EXPERT</b>	EXPERIENCE	ESSENTIAL
Power source	Petrol 2-stroke	Petrol 2-stroke	Petrol 2-stroke
Power	3.1 kW	0.8 kW	0.8 kW
Displacement	75.6 cc	27.6 cc	27.6 cc
Engine rotation speed	7000 rpm	7500 rpm	7500 rpm
Fuel tank capacity	2.1 L	0.45 L	0.45 L
Maximum air volume	25 m <sup>3</sup> /min	10.2 m <sup>3</sup> /min	10.2 m <sup>3</sup> /min
Maximum air speed	100 m/s	72 m/s	72 m/s
Vibration level hand (m/s <sup>2</sup> )	2	2	2
Product weight	10 kg	4.8 kg	4.8 kg
Art.-Nr.	255175102/S17	255127002/15	255127092/ST1
Warranty	2-Years	2-Years	2-Years

## SAB 900 AE



## SAB 500 AE



## SAB 700 AE



## SAB 100 AE KIT



BATTERY	SAB 900 AE	SAB 700 AE	SAB 500 AE	SAB 100 AE KIT
Level	<b>EXPERT</b>	EXPERIENCE	EXPERIENCE	ESSENTIAL
Series	900 series	700 series	500 series	100 series
Power source	Lithium-ion battery	Lithium-ion battery	Lithium-ion battery	Lithium-ion battery
Recommended battery	2 x 7.5 Ah ( <b>Not Included</b> )	4 Ah ( <b>Not Included</b> )	4 Ah ( <b>Not Included</b> )	4 Ah (Battery & charger included)
Power	0.9 kW	0.5 kW	0.48 kW	0.28 kW
Motor type	Brushless	Brushless	Brushless	With brushes
Voltage	48 V	48 V	48 V	20 V
Battery type	Lithium-ions	Lithium-ions	Lithium-ions	Lithium-ions
Working time (+/- 20%)	100 min	18 - 120 min dependent on speed control	32 min	20 min
Maximum air volume	15.8 m³/min	11.6 m³/min	11.4 m³/min	9 m³/min
Maximum air speed	55 m/s	60 m/s	51.4 m/s	32 m/s
Vibration level hand (m/s²)	-	-	2.27	0.83
Product weight	3.76 kg	2.76 kg	3.1 kg	2.14 kg
Art.-Nr.	279500008/ST1	277500008/ST1	278500008/ST2	271504208/UKS
Warranty	2-Years	2-Years	2-Years	2-Years

ELECTRIC	SBL 2600
Level	ESSENTIAL
Power source	Electric
Power	2.6 kW
Power Cable	15m (available separately)
Maximum air volume	7 m³/min
Maximum air speed	92 m/s
Vacuum function	Yes
Vacuum bag capacity	45 L
Vibration level hand (m/s²)	1.7
Product weight	3.3 kg
Art.-Nr.	
Warranty	2-Years



# Sweepers

The easiest way to remove leaves and debris from driveways or footpaths

STIGA sweepers are the perfect garden accessory for all seasons - great for cleaning footpaths, lawns and outdoor areas. Whether you need a manual or motorised product we are sure you will find the right sweeper to suit your cleaning requirements – from fallen leaves, dirt, debris, lawn clippings and even snow!



## PUSH SWEEPER

STIGA outdoor push sweepers are easy-to-use, easy to manoeuvre, perfect for cleaning dust, dirt and residues from various hard surfaces. These lightweight, quiet sweepers are equipped with hard wearing brushes and have one of the best collecting systems in this category. They can easily collect compressed plastic bottles, cans and small stones – making large areas easy to keep clean.



## PETROL SWEEPERS

STIGA petrol outdoor sweepers are the perfect product for cleaning driveways and footpaths all year round, whether you need to clear leaves, lawn clippings or snow. Equipped with powerful brushes and pneumatic tyres, so you can take on even the most challenging tasks.



PUSH	SWP 577	SWP 475	SWP 355
Level	EXPERIENCE	EXPERIENCE	ESSENTIAL
Working width	77 cm	75 cm	55 cm
Sweeping performance	3000 m <sup>2</sup>	2900 m <sup>2</sup>	1600 m <sup>2</sup>
Brush height adjustment	Yes - 8 steps	Yes - 8 steps	Yes - 3 steps
Brush diameter / brush material	410 mm / Nylon	410 mm / Nylon	300 mm / Nylon
Rotating brush roller	Yes	Yes	Yes
Edge guiding roller	Yes	-	Yes
Flexible seals	Yes	-	-
Gear protection cover	Yes	-	-
Driving	Push	Push	Push
Air filter	Yes	-	-
Collector capacity	50 L	50 L	20 L
Handlebar type	Ergonomic	Flat	Ergonomic
Wheels size Ø	275 mm	250 mm	210 mm
Packaged dimensions (LxWxH)	800 x 300 x 870 mm	790 x 290 x 845 mm	560 x 225 x 639 mm
Product weight	14.6 kg	11.2 kg	7.2 kg
Art.-Nr.	2W0775012/ST1	2W0755011/ST1	2W0552511/ST1
Warranty	2-Years	2-Years	2-Years



PETROL	SWS 800 G	SWS 600 G
Level	ESSENTIAL	ESSENTIAL
Engine Brand	Stiga SM 70	Stiga SM 70
Displacement	212 cc	212 cc
Engine net power	4.40 kW @ 3600 RPM	4.40 kW @ 3600 RPM
Fuel tank capacity	3 L	3 L
Working width	80 cm	60 cm
Brush diameter	345 mm	345 mm
Max angle adjustment (left/right)	15°/15°	15°/15°
Driving	Self propelled	Self propelled
Number of gears	6 forward + 2 reverse	6 forward + 2 reverse
Wheels	14x4.60-6	14x4.60-6
Vibrations level	5.2 m/s <sup>2</sup>	5.2 m/s <sup>2</sup>
Sound power level (LWA)	99 dB(A)	99 dB(A)
Product weight	70 kg	65 kg
Art.-Nr.	219802532/S17	219602532/S17
Warranty	2-Years	2-Years

## Accessories and attachments

Product name	Art. N.	Pos	SWEeper 800	SWEeper 600
Collecting box 80 cm - 7 kg	290802020/16	1	•	
Collecting box 60 cm - 6 kg	290602020/16	2		•
Front blade 80 cm - 6 kg	290802030/16	3	•	



1-2  
Collecting box



3-4  
Front blade

# Batteries and chargers

The SBH 900 is for use with the 900 and 700 Series battery range of handtools

- Comfortable battery harness for effortless gardening
- Holds 2 batteries - doubling the power available whilst freeing the hand-held tool from the battery weight
- Easy to switch over from one battery the other for uninterrupted runtime
- Adjustable harness clips distribute the battery weight perfectly
- Dummy battery accessory connects the harness to the STIGA 700 Series tools



## Battery harness

Code	Name	Weight
279050008/ST1	SBH 900 AE	3,4 Kg



## Battery simulator

Code	Name	Weight
277010008/ST1	E 400	0,9 Kg

## 20V batteries



Code	Name	Capacity	Energy	Charging time	Weight	Fits for
271012008/ST1	E 22	2.0 Ah	36 Wh	70 min	0,39 Kg	SGT 100 AE Kit - SHT 100 AE Kit - SAB 100 AE Kit - SMT 100 AE Kit COLLECTOR 132 AE Kit - COLLECTOR 136 AE Kit - COLLECTOR 140 AE Kit
271014008/ST1	E 24	4.0 Ah	72 Wh	140 min	0,65 Kg	SGT 100 AE Kit - SHT 100 AE Kit - SAB 100 AE Kit - SMT 100 AE Kit COLLECTOR 132 AE Kit - COLLECTOR 136 AE Kit - COLLECTOR 140 AE Kit

## 20V chargers



Code	Name	Type	Amperage	Weight	Fits for
271021000/21	C 215 SU	Single Standard	2.0 A	0,35 Kg	SGT 100 AE Kit - SHT 100 AE Kit - SAB 100 AE Kit - SMT 100 AE Kit COLLECTOR 132 AE Kit - COLLECTOR 136 AE Kit - COLLECTOR 140 AE Kit
271021100/21	C 215 DU	Dual Standard	2.0 A	0,6 Kg	SGT 100 AE Kit - SHT 100 AE Kit - SAB 100 AE Kit - SMT 100 AE Kit COLLECTOR 132 AE Kit - COLLECTOR 136 AE Kit - COLLECTOR 140 AE Kit

## 48V batteries



Code	Name	Capacity	Energy	Charging time (std)	Charging time (fast)	Weight	Fits for
277012008/ST1	E 420	2.0 Ah	86.4 Wh	90 min	50 min	0,9 Kg	SGT 500 AE - SBC 500 AE - SAB 500 AE - SHT 500 AE - SPR 500 AE SMT 500 AE - SBC 700 AE - SBC 700 D AE - SAB 700 AE - SHT 500 AE SPH 700 AE - SPS 700 AE - SLM 536 AE - SLM 540 AE - SLM 544 AE
277014008/ST1	E 440	4.0 Ah	172.8 Wh	180 min	110 min	1,4 Kg	COMBI 748 Q AE - MULTICLIP 747 AE - MULTICLIP 747 AE - COMBI 748 SQ AE COMBI 753 SQ AE - MULTICLIP 750 S AE
277015008/ST1	E 450	5.0 Ah	216 Wh	220 min	120 min	1,5 Kg	
277017008/ST1	E 475	7.5 Ah	324 Wh	330 min	180 min	2,2 Kg	SBC 900 D AE - SAB 900 AE - SHT 900 AE - SPH 900 AE COMBI 950 SQ AE - COMBI 955 SQ AE - TWINCLIP 950 SQ AE MULTICLIP PRO 950 SX AE

## 48V chargers



Single



Dual



Fast

Code	Name	Type	Output current	Net weight	Fits for
277021008/ST1	C 415 SU	Standard	1.5 A	0,6 Kg	SGT 500 AE - SBC 500 AE - SAB 500 AE - SHT 500 AE - SPR 500 AE SMT 500 AE SBC 700 AE - SBC 700 D AE - SAB 700 AE - SHT 500 AE SPH 700 AE - SPS 700 AE - SBC 900 D AE - SAB 900 AE - SHT 900 AE SPH 900 AE
277031008/ST1	C 430 FU	Fast	3.0 A	0,75 Kg	SLM 536 AE - SLM 540 AE - SLM 544 AE - COLLECTOR 543 AE Kit COLLECTOR 548 AE Kit - COLLECTOR 548 S AE Kit - MULTICLIP 547 AE Kit COMBI 748 Q AE - MULTICLIP 747 AE Kit MULTICLIP 747 AE - COMBI 748 SQ AE - COMBI 753 SQ AE MULTICLIP 750 S AE
277021208/ST1	C 415 DU	Dual Standard	1.5 A	1,0 Kg	COMBI 950 SQ AE - COMBI 955 SQ AE TWINCLIP 950 SQ AE - MULTICLIP PRO 950 SX AE



# Accessories

For top quality results and to ensure the best performance

STIGA accessories are developed alongside our main equipment to ensure quality and safety, carrying out strict tests and careful checks throughout the process.

Our range also includes safety jackets and trousers, gloves, braces and helmets to perform even the toughest outdoor work in total comfort and safety.

STIGA original oils help keeping every STIGA tool at its best, operating smoothly in all weather conditions and extending its lifespan.





## Forestal jacket

Working jacket made in 4-way stretch micro-rip fabric.



### Packaging

Dimensions: 38.5x29x10 cm  
Gross weight: 1.240 kg

Code	EAN	Description	Size
1599-1928-01	8008989902409	Forest jacket	S
1599-1928-11	8008989902416	Forest jacket	M
1599-1928-21	8008989902423	Forest jacket	L
1599-1928-31	8008989902430	Forest jacket	XL
1599-1928-41	8008989902447	Forest jacket	XXL

## Protective trousers

Chainsaw protective trousers class 1 type class 1 type A (20m/s) made in 4-way stretch water repellent fabric.



### Packaging

Dimensions: 38.5x29x10 cm  
Gross weight: 1.760 kg

Code	EAN	Description	Size
1599-1929-01	8008989902454	Protective trousers	S
1599-1929-11	8008989902461	Protective trousers	M
1599-1929-21	8008989902478	Protective trousers	L
1599-1929-31	8008989902485	Protective trousers	XL
1599-1929-41	8008989902492	Protective trousers	XXL

## Protective leggings

Chainsaw protective leggings class 1 type A (20m/s)



### Packaging

Dimensions: 49x363.5x4 cm  
Gross weight: 1.310Kg

Code	EAN	Description	Size
1599-1924-00	8008989902508	Protective leggings	Unique size

## Technical gloves

Working gloves in compliance with EN 388 (3-1-2-2). Protects against mechanical risks.



### Packaging

Dimensions: 31x12x3 cm  
Gross weight: 0.113 kg

Code	EAN	Description	Size
1599-1931-01	8008989902515	Technical gloves	8
1599-1931-11	8008989902522	Technical gloves	9
1599-1931-21	8008989902539	Technical gloves	10
1599-1931-31	8008989902546	Technical gloves	11
1599-1931-41	8008989902553	Technical gloves	12

## Braces

Braces available with loops and with clips. Unique size.



1



### Packaging

Dimensions: 12.3x32x3 cm  
Gross weight: 0.150 kg

Pos	Code	EAN	Description	Size
1	1599-1941-00	8008989902652	Braces with loops	One size

## Helmet

Made in ABS with stainless steel visor, earmuffs (26db SNR) and one hand ratchet system. Weighs 650 gr.



### Packaging

Dimensions: 30x25x16.6 cm  
Gross weight: 0.700 kg

Code	EAN	Description	Size
1599-1913-11	8008989903772	Helmet	One size

# Chain Oil

## MINERAL

High-viscosity oil has been developed for lubrication of all types of pressure-fed chainsaws.

### IDEAL FOR



## FAST BIODEGRADABLE

Environmentally-friendly chainsaw oil based on harvestable raw materials.

### IDEAL FOR



Code	EAN	Pos	Type	Capacity	Note
1111-9228-01	7313329115076	1	Mineral	1 L	Export
1111-9229-01	7313329115083	2	Mineral	5 L	Export
1111-9276-01	7313324000841	3	Biodegradable	1 L	Export + Italy
1111-9247-01	7313329115267	4	Biodegradable	5 L	Export + Italy

# 2 Stroke Oil

Synthetic 100% is certified JASO FD that guarantees a superior quality and a better oiling. A superior quality means a better lubrication, less dirt on spark plugs and less leftovers in the cylinder; the engine will release less emissions and perform better.

### IDEAL FOR

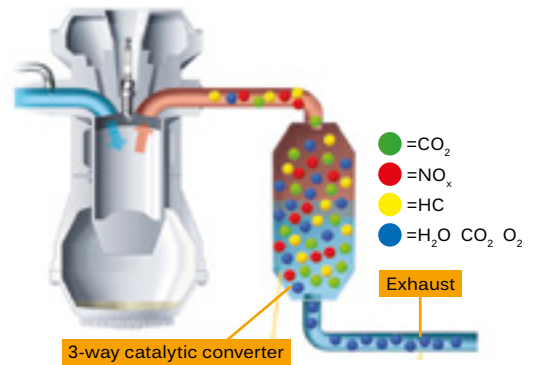

Pos	Code	EAN	Type	Specification	Capacity	Note	Bottle dim.	Pcs/box	Box/pallet
1	1111-9230-01	7313329115090	Synthetic 100%	API TC - JASO FD ISO-L-EGD	1 L dozer	Export	14x5.7x25 cm	12	28
2	1111-9231-01	7313329115106	Synthetic 100%	API TC - JASO FD ISO-L-EGD	0.1 L	Export	5x5x10 cm	2 kit of 20	60

# 4 Stroke Oil and Transmission Oil

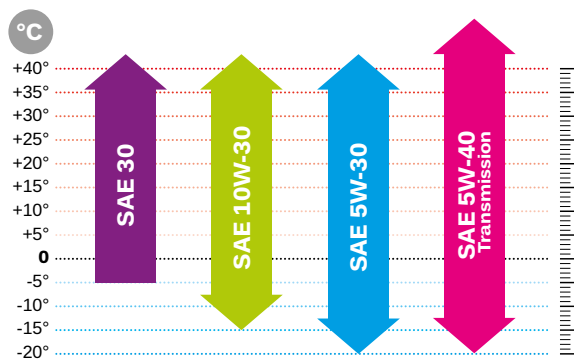

Temperature performance

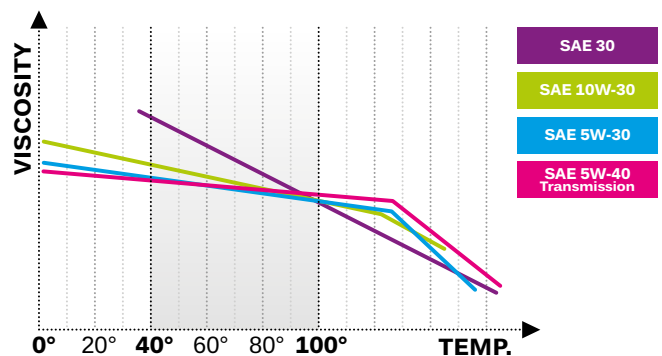

Viscosity performance

## 4 Stroke Oil

SAE 30 is superb for use from 0°C ambient temperature, the specifications API SL/CF mean that it is suitable for both diesel engines with and without turbo charger. SAE 10W-30 designates a multigrade-oil. "10W" and 5V viscosity of the oil at cold temperature and the number 30 indicates the viscosity at 100°C.

### IDEAL FOR



### SAE 5W-30 ALSO IDEAL FOR



Pos	Code	EAN	Type	Specification	Capacity	Note	Pcs/box	Box/pallet
1	1111-9234-01	7313329115090	SAE 30	API SL/CF - ACEA A3/B4	0.6 L	Export	16	35
2	1111-9235-01	7313329115137	SAE 30	API SL/CF - ACEA A3/B4	1 L	Export	12	36
3	1111-9236-01	7313329115144	SAE 30	API SL/CF - ACEA A3/B4	1.4 L	Export	12	36
4	1111-9237-01	7313329115151	SAE 10W-30	API SL/CF - ACEA A3/B4	0.6 L	Export	16	35
5	1111-9238-01	7313329115168	SAE 10W-30	API SL/CF - ACEA A3/B4	1.4 L	Export	12	36
6	1111-9242-01	7313329115175	SAE 5W-30	API SL/CF - ACEA A3/B4	1.4 L	Export	12	36

## Transmission Oil

The transmission fluid plays a very important role in the whole system. It serves as a hydraulic element, keeping it clean and well lubricated, and keeps the temperature at the right level.

### IDEAL FOR



Pos	Code	EAN	Type	Specification	Capacity	Note	Bottle dim.	Pcs/box	Box/pallet
1	1111-9240-01	7313329115199	SAE 5W-40	API GL-4/GL-5	1.4 L	Export	13x6.8x25.4 cm	12	36
2	1111-9241-01	7313329115205	SAE 5W-40	API GL-4/GL-5	4 L	Export	10.5x20.5x29 cm	5	18
n.a.	1111-9281-01	8008984813175	SAE 5W-50	API GL-4/GL-5 + LS	1.4 L	Export	13x6.8x25.4 cm	12	36
n.a.	1111-9282-01	8008984813182	SAE 5W-50	API GL-4/GL-5 + LS	5 L	Export	n.a.	n.a.	n.a.
n.a.	1111-9300-01	7313324005839	SAE 5W-50	API GL-4/GL-5 + LS	60 L	Export	n.a.	n.a.	n.a.

## Cans

The yellow fuel can is certified for land and sea transport. The dispenser allows the liquid to run out continuously without any over-flowing. The cap has special seals suitable to be in contact with the various types of hydrocarbons. The combican canister holds 5 litres of petrol and 2 litres of oil. The 2 cans can be separated.

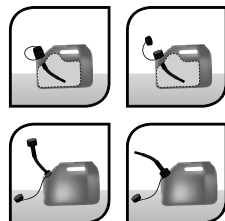

### Packaging

Dimensions: 28x19x18 cm  
Gross weight: 0.500 kg

### Instructions for Can

For Fuel

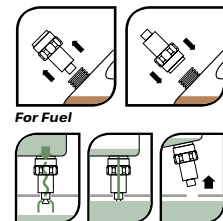

### Packaging

Dimensions: 31x29.5x15 cm  
Gross weight: 1.065 kg

### Instructions for Combican

For Oil/Fuel

Pos	Code	EAN	Type	Capacity
1	1111-0001-01	7313329115038	Can	5 L
2	1911-9144-01	7313329191209	Combican	5 L + 2 L

# Toys

Kids will just love being outside

For all the little gardeners around the world, STIGA has a selection of toy machines; a perfect reproduction of a STIGA garden tractor or lawnmower, that allows your child to enjoy the outdoors and feel like a pro! All the toys are made of plastic, totally safe and a lot of fun!



PUSH	TOY MOWER
Level	<b>EXPERT</b>
Age	2.5 - 5 years
Made in	Italy
Product weight	2.2 kg
Art.-Nr.	2G1100000/ST1



PEDAL TOY TRACTOR	MINI-T 300	MINI-T 250
Level	<b>EXPERT</b>	<b>EXPERT</b>
Age	3 – 8 years	2.5 – 5 years
Equipment	Trailer hitch kit	Trailer hitch kit
Made in	Germany	Germany
Product weight	15.7 kg	8 kg
Art.-Nr.	2G2000100/ST1	2G1000100/ST1













**STIGA Ltd**

Unit 8, Bluewater Estate,  
Bell Close, Plymouth, PL7 4JH

[www.stigalawnmowers.co.uk](http://www.stigalawnmowers.co.uk)

*E&OE STIGA Ltd has a policy of continuous improvement and reserves the right to change models and specifications without prior notification*

February 2021